

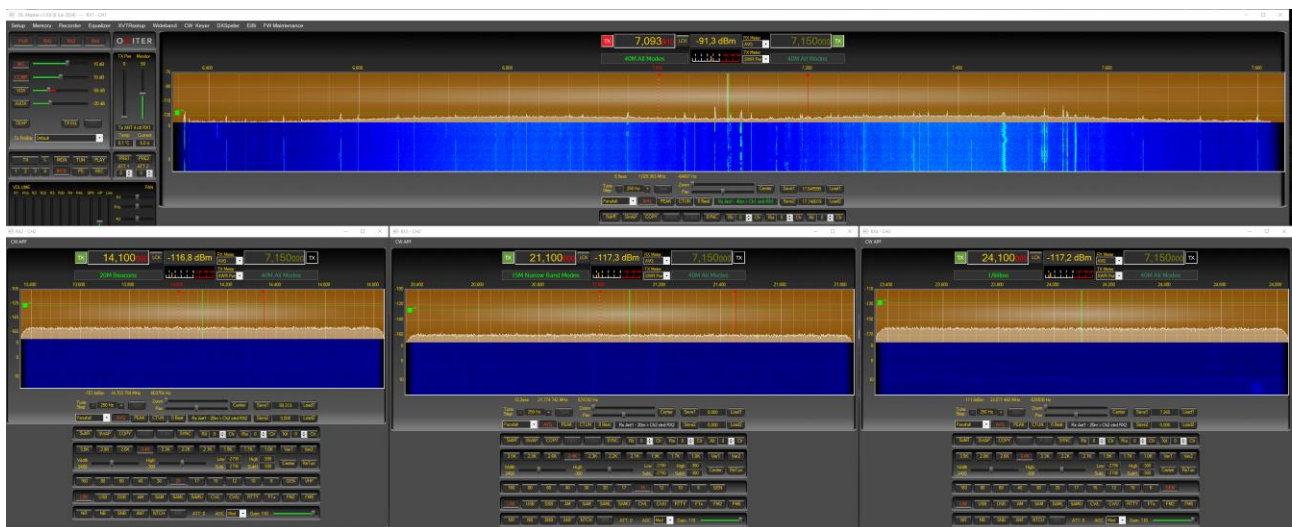

# OL-SD20A

## SDR Transceiver

*First startup guide*



## Contents of this manual

Contents of this manual.....	2
1. Disclaimer for Proper Use of Amateur SDR Transceiver .....	5
a. Proper Connection and Installation.....	5
b. Liability .....	5
c. Warranty and Damage .....	5
d. Electrostatic Discharge (ESD) Precautions .....	5
e. Safety and Compliance .....	5
f. Acknowledgement .....	5
2. Software license .....	6
a. License terms .....	6
b. Warranty disclaimer .....	6
c. Obtaining the source code.....	6
- Source code request .....	7
d. Full GNU GPL version 3.0 license .....	8
e. Contact information .....	15
3. Hardware license.....	16
a. Hardware terms and conditions .....	16
b. License grant .....	16
c. Intellectual property rights.....	16
d. Restrictions.....	16
e. Warranty disclaimer .....	16
f. Limitation of Liability .....	17
g. Indemnification .....	17
h. Termination.....	17
i. Governing Law .....	17
j. Entire Agreement.....	17
k. Amendments .....	17
l. Contact information .....	18
4. Introduction.....	19
5. Device overview.....	19
a. Front panel .....	20
b. Back panel .....	21
c. Connectors description .....	22
- Morse key jack.....	22

-	Headphones output.....	23
-	Microphone input .....	23
-	Front panel LEDs .....	25
-	Front speakers .....	25
-	Transverter interfaces.....	25
-	EXT IN .....	26
-	10MHz references .....	26
-	PA Band connector .....	27
-	ACC connector.....	28
-	OC connector.....	29
-	Power connector .....	30
-	Antenna connectors .....	30
6.	System requirements.....	31
a.	Software requirements .....	32
-	Operating system requirements .....	32
-	.NET Framework requirements.....	32
-	Microsoft Visual C++ Redistributable .....	32
b.	Hardware requirements.....	32
c.	Network requirements.....	33
7.	Installing OL-Master.....	34
8.	Wiring the transceiver .....	36
a.	Connecting of the PureSignal cable.....	37
b.	Connecting the power supply .....	38
c.	Connecting the antenna .....	39
d.	Ethernet connection .....	40
e.	Connecting the microphone .....	40
9.	Configuring the firewall .....	41
10.	Connection of the SDR to the PC.....	46
a.	Default Olliter SDR IP address. ....	46
b.	Sample Ethernet connection. ....	46
c.	Changing the Olliter SDR IP address.....	47
-	Connect the device to the PC .....	47
-	Manually set the IP address of the PC .....	47
-	Setting the device address using OL-Master .....	50
-	Restore the default IP settings of the PC .....	52
11.	Usage of OL-Master.....	56

a.	Configuring OL-Master .....	56
-	Configuring the Olliter SDR address .....	57
-	Configuring the operator settings .....	58
-	Configuring the audio interface .....	59
-	Configuring the receiver bandwidth .....	60
-	Configuring the refresh rate .....	61
b.	Starting the device.....	62
c.	Using the OL-Master software.....	63
-	Selecting a different band .....	64
-	Tuning a frequency .....	65
-	Interacting with the spectrum .....	67
-	Setting the receiver mode .....	68
-	Adding additional receivers.....	69
-	Adjusting the receivers volume .....	70
-	DSP options .....	71
12.	Troubleshooting .....	72
a.	Olliter SDR Not Powering Up .....	72

## 1. Disclaimer for Proper Use of Amateur SDR Transceiver



Please read the following disclaimer carefully before using the SDR transceiver.

### a. Proper Connection and Installation

The connection and installation of the SDR transceiver are the sole responsibility of the user. It is crucial that all connections are made by the user in accordance with industry standards and best practices to ensure the safety and proper functionality of the equipment.

### b. Liability

Olliter SAGl shall not be held liable for any damages resulting from the improper use or incorrect installation of the SDR transceiver, whether such damages occur to the user or any third parties. This includes, but is not limited to, physical damage to the equipment, loss of data, or any other consequential damages.

### c. Warranty and Damage

In the event of equipment damage, if it is determined that the cause of damage was improper use or incorrect connection by the user, Olliter SAGl will not honor any warranty claims. Users are strongly encouraged to follow all usage instructions and safety guidelines to prevent voiding the warranty.

### d. Electrostatic Discharge (ESD) Precautions

Users must take appropriate precautions to protect the SDR transceiver from electrostatic discharge (ESD). Failure to implement ESD protection measures can result in permanent damage to the device. ESD precautions include, but are not limited to, using an ESD wrist strap when handling connectors or any interface of the device, properly grounding all equipment, and working on an ESD-safe surface.

### e. Safety and Compliance

Users must ensure that their use of the SDR transceiver complies with all local laws and regulations. This includes adhering to frequency allocation rules, power output restrictions, and any other regulatory requirements pertaining to the operation of amateur radio equipment.

### f. Acknowledgement

By using the SDR transceiver, you acknowledge that you have read and understood this disclaimer and agree to comply with all guidelines and precautions outlined herein. Failure to do so may result in equipment damage, legal consequences, or personal injury, for which OLLITER will not be responsible.

Thank you for your understanding and cooperation. Enjoy your SDR transceiver safely and responsibly.

## 2. Software license

This software contains GNU GPL code, meaning any derivative must share the same license terms. Here are the licensing terms related to OL-Master software.

By using this software, you acknowledge that you have read and understood the terms of the GNU General Public License and agree to comply with them.

The full GNU GPL license versions 2 and 3 are available at the following addresses:

- <https://www.gnu.org/licenses/old-licenses/gpl-2.0.html>
- <https://www.gnu.org/licenses/gpl-3.0.html>

Terms of this license are also reported in the Full GNU GPL version 3.0 license chapter.

### a. License terms

This software, OL-Master, is derived from PowerSDR, a C# implementation of a Software Defined Radio. The original PowerSDR software and our derived version are distributed under the terms of the GNU General Public License (GPL), version 2, or any later version as published by the Free Software Foundation.

Under the terms of the GPL, you are granted the following rights:

- Freedom to Use: You may use this software for any purpose.
- Freedom to Study and Modify: You may study how the program works and modify it to suit your needs. Access to the source code is a precondition for this freedom.
- Freedom to Distribute Copies: You may redistribute copies of the original program so you can help others.
- Freedom to Distribute Modified Versions: You may distribute copies of your modified versions to others under the same license. By doing this, you can give the whole community a chance to benefit from your changes.

### b. Warranty disclaimer

This program is distributed in the hope that it will be useful, but WITHOUT ANY WARRANTY; without even the implied warranty of MERCHANTABILITY or FITNESS FOR A PARTICULAR PURPOSE. See the GNU General Public License for more details.

### c. Obtaining the source code

In compliance with the GPL, the complete corresponding source code for this software is available. The source code includes all the necessary files to compile, install, and run the software, as well as any modifications and enhancements we have made.

- Source code request

To obtain the source code, a written offer should be performed to receive the source code on a physical medium, you can request it by sending a written request to the following address:

*Olliter Laboratory SAgI*

*Amsler 1,*

*CH-7304 Maienfeld*

Or, via email at the following address:

[legal@olliter.com](mailto:legal@olliter.com)

The source code will be provided on a physical medium (e.g., CD, USB drive) for a reasonable fee (that may vary depending on the requester location) to cover the costs of media, shipping, and handling. This offer is valid for three years from the date you received the binary version of the software.

## d. Full GNU GPL version 3.0 license

### GNU GENERAL PUBLIC LICENSE

Version 3, 29 June 2007

Copyright © 2007 Free Software Foundation, Inc. <<https://fsf.org/>>

Everyone is permitted to copy and distribute verbatim copies of this license document, but changing it is not allowed.

#### Preamble

The GNU General Public License is a free, copyleft license for software and other kinds of works.

The licenses for most software and other practical works are designed to take away your freedom to share and change the works. By contrast, the GNU General Public License is intended to guarantee your freedom to share and change all versions of a program--to make sure it remains free software for all its users. We, the Free Software Foundation, use the GNU General Public License for most of our software; it applies also to any other work released this way by its authors. You can apply it to your programs, too.

When we speak of free software, we are referring to freedom, not price. Our General Public Licenses are designed to make sure that you have the freedom to distribute copies of free software (and charge for them if you wish), that you receive source code or can get it if you want it, that you can change the software or use pieces of it in new free programs, and that you know you can do these things.

To protect your rights, we need to prevent others from denying you these rights or asking you to surrender the rights. Therefore, you have certain responsibilities if you distribute copies of the software, or if you modify it: responsibilities to respect the freedom of others.

For example, if you distribute copies of such a program, whether gratis or for a fee, you must pass on to the recipients the same freedoms that you received. You must make sure that they, too, receive or can get the source code. And you must show them these terms so they know their rights.

Developers that use the GNU GPL protect your rights with two steps: (1) assert copyright on the software, and (2) offer you this License giving you legal permission to copy, distribute and/or modify it.

For the developers' and authors' protection, the GPL clearly explains that there is no warranty for this free software. For both users' and authors' sake, the GPL requires that modified versions be marked as changed, so that their problems will not be attributed erroneously to authors of previous versions.

Some devices are designed to deny users access to install or run modified versions of the software inside them, although the manufacturer can do so. This is fundamentally incompatible with the aim of protecting users' freedom to change the software. The systematic pattern of such abuse occurs in the area of products for individuals to use, which is precisely where it is most unacceptable. Therefore, we have designed this version of the GPL to prohibit the practice for those products. If such problems arise substantially in other domains, we stand ready to extend this provision to those domains in future versions of the GPL, as needed to protect the freedom of users.

Finally, every program is threatened constantly by software patents. States should not allow patents to restrict development and use of software on general-purpose computers, but in those that do, we wish to avoid the special danger that patents applied to a free program could make it effectively proprietary. To prevent this, the GPL assures that patents cannot be used to render the program non-free.

The precise terms and conditions for copying, distribution and modification follow.

#### TERMS AND CONDITIONS

##### 0. Definitions.

“This License” refers to version 3 of the GNU General Public License.

“Copyright” also means copyright-like laws that apply to other kinds of works, such as semiconductor masks.

“The Program” refers to any copyrightable work licensed under this License. Each licensee is addressed as “you”. “Licensees” and “recipients” may be individuals or organizations.

To “modify” a work means to copy from or adapt all or part of the work in a fashion requiring copyright permission, other than the making of an exact copy. The resulting work is called a “modified version” of the earlier work or a work “based on” the earlier work.

A “covered work” means either the unmodified Program or a work based on the Program.



To “propagate” a work means to do anything with it that, without permission, would make you directly or secondarily liable for infringement under applicable copyright law, except executing it on a computer or modifying a private copy. Propagation includes copying, distribution (with or without modification), making available to the public, and in some countries other activities as well.

To “convey” a work means any kind of propagation that enables other parties to make or receive copies. Mere interaction with a user through a computer network, with no transfer of a copy, is not conveying.

An interactive user interface displays “Appropriate Legal Notices” to the extent that it includes a convenient and prominently visible feature that (1) displays an appropriate copyright notice, and (2) tells the user that there is no warranty for the work (except to the extent that warranties are provided), that licensees may convey the work under this License, and how to view a copy of this License. If the interface presents a list of user commands or options, such as a menu, a prominent item in the list meets this criterion.

### 1. Source Code.

The “source code” for a work means the preferred form of the work for making modifications to it. “Object code” means any non-source form of a work.

A “Standard Interface” means an interface that either is an official standard defined by a recognized standards body, or, in the case of interfaces specified for a particular programming language, one that is widely used among developers working in that language.

The “System Libraries” of an executable work include anything, other than the work as a whole, that (a) is included in the normal form of packaging a Major Component, but which is not part of that Major Component, and (b) serves only to enable use of the work with that Major Component, or to implement a Standard Interface for which an implementation is available to the public in source code form. A “Major Component”, in this context, means a major essential component (kernel, window system, and so on) of the specific operating system (if any) on which the executable work runs, or a compiler used to produce the work, or an object code interpreter used to run it.

The “Corresponding Source” for a work in object code form means all the source code needed to generate, install, and (for an executable work) run the object code and to modify the work, including scripts to control those activities. However, it does not include the work’s System Libraries, or general-purpose tools or generally available free programs which are used unmodified in performing those activities but which are not part of the work. For example, Corresponding Source includes interface definition files associated with source files for the work, and the source code for shared libraries and dynamically linked subprograms that the work is specifically designed to require, such as by intimate data communication or control flow between those subprograms and other parts of the work.

The Corresponding Source need not include anything that users can regenerate automatically from other parts of the Corresponding Source.

The Corresponding Source for a work in source code form is that same work.

### 2. Basic Permissions.

All rights granted under this License are granted for the term of copyright on the Program, and are irrevocable provided the stated conditions are met. This License explicitly affirms your unlimited permission to run the unmodified Program. The output from running a covered work is covered by this License only if the output, given its content, constitutes a covered work. This License acknowledges your rights of fair use or other equivalent, as provided by copyright law.

You may make, run and propagate covered works that you do not convey, without conditions so long as your license otherwise remains in force. You may convey covered works to others for the sole purpose of having them make modifications exclusively for you, or provide you with facilities for running those works, provided that you comply with the terms of this License in conveying all material for which you do not control copyright. Those thus making or running the covered works for you must do so exclusively on your behalf, under your direction and control, on terms that prohibit them from making any copies of your copyrighted material outside their relationship with you.

Conveying under any other circumstances is permitted solely under the conditions stated below. Sublicensing is not allowed; section 10 makes it unnecessary.

### 3. Protecting Users' Legal Rights From Anti-Circumvention Law.

No covered work shall be deemed part of an effective technological measure under any applicable law fulfilling obligations under article 11 of the WIPO copyright treaty adopted on 20 December 1996, or similar laws prohibiting or restricting circumvention of such measures.

When you convey a covered work, you waive any legal power to forbid circumvention of technological measures to the extent such circumvention is effected by exercising rights under this License with respect to the covered work, and you disclaim any intention to limit operation or modification of the work as a means of enforcing, against the work’s users, your or third parties’ legal rights to forbid circumvention of technological measures.

### 4. Conveying Verbatim Copies.

You may convey verbatim copies of the Program's source code as you receive it, in any medium, provided that you conspicuously and appropriately publish on each copy an appropriate copyright notice; keep intact all notices stating that this License and any non-permissive terms added in accord with section 7 apply to the code; keep intact all notices of the absence of any warranty; and give all recipients a copy of this License along with the Program.

You may charge any price or no price for each copy that you convey, and you may offer support or warranty protection for a fee.

#### 5. Conveying Modified Source Versions.

You may convey a work based on the Program, or the modifications to produce it from the Program, in the form of source code under the terms of section 4, provided that you also meet all of these conditions:

- a) The work must carry prominent notices stating that you modified it, and giving a relevant date.
- b) The work must carry prominent notices stating that it is released under this License and any conditions added under section 7. This requirement modifies the requirement in section 4 to "keep intact all notices".
- c) You must license the entire work, as a whole, under this License to anyone who comes into possession of a copy. This License will therefore apply, along with any applicable section 7 additional terms, to the whole of the work, and all its parts, regardless of how they are packaged. This License gives no permission to license the work in any other way, but it does not invalidate such permission if you have separately received it.
- d) If the work has interactive user interfaces, each must display Appropriate Legal Notices; however, if the Program has interactive interfaces that do not display Appropriate Legal Notices, your work need not make them do so.

A compilation of a covered work with other separate and independent works, which are not by their nature extensions of the covered work, and which are not combined with it such as to form a larger program, in or on a volume of a storage or distribution medium, is called an "aggregate" if the compilation and its resulting copyright are not used to limit the access or legal rights of the compilation's users beyond what the individual works permit. Inclusion of a covered work in an aggregate does not cause this License to apply to the other parts of the aggregate.

#### 6. Conveying Non-Source Forms.

You may convey a covered work in object code form under the terms of sections 4 and 5, provided that you also convey the machine-readable Corresponding Source under the terms of this License, in one of these ways:

- a) Convey the object code in, or embodied in, a physical product (including a physical distribution medium), accompanied by the Corresponding Source fixed on a durable physical medium customarily used for software interchange.
- b) Convey the object code in, or embodied in, a physical product (including a physical distribution medium), accompanied by a written offer, valid for at least three years and valid for as long as you offer spare parts or customer support for that product model, to give anyone who possesses the object code either (1) a copy of the Corresponding Source for all the software in the product that is covered by this License, on a durable physical medium customarily used for software interchange, for a price no more than your reasonable cost of physically performing this conveying of source, or (2) access to copy the Corresponding Source from a network server at no charge.
- c) Convey individual copies of the object code with a copy of the written offer to provide the Corresponding Source. This alternative is allowed only occasionally and noncommercially, and only if you received the object code with such an offer, in accord with subsection 6b.
- d) Convey the object code by offering access from a designated place (gratis or for a charge), and offer equivalent access to the Corresponding Source in the same way through the same place at no further charge. You need not require recipients to copy the Corresponding Source along with the object code. If the place to copy the object code is a network server, the Corresponding Source may be on a different server (operated by you or a third party) that supports equivalent copying facilities, provided you maintain clear directions next to the object code saying where to find the Corresponding Source. Regardless of what server hosts the Corresponding Source, you remain obligated to ensure that it is available for as long as needed to satisfy these requirements.
- e) Convey the object code using peer-to-peer transmission, provided you inform other peers where the object code and Corresponding Source of the work are being offered to the general public at no charge under subsection 6d.

A separable portion of the object code, whose source code is excluded from the Corresponding Source as a System Library, need not be included in conveying the object code work.

A "User Product" is either (1) a "consumer product", which means any tangible personal property which is normally used for personal, family, or household purposes, or (2) anything designed or sold for incorporation into a dwelling. In determining whether a product is a consumer product, doubtful cases shall be resolved in favor of coverage. For a particular product received by a particular user, "normally used" refers to a typical or common use of that class of product, regardless of the status of the particular user or of the way in which the particular user actually uses, or expects or is expected to use, the product. A product is a consumer product regardless of whether the product has substantial commercial, industrial or non-consumer uses, unless such uses represent the only significant mode of use of the product.

“Installation Information” for a User Product means any methods, procedures, authorization keys, or other information required to install and execute modified versions of a covered work in that User Product from a modified version of its Corresponding Source. The information must suffice to ensure that the continued functioning of the modified object code is in no case prevented or interfered with solely because modification has been made.

If you convey an object code work under this section in, or with, or specifically for use in, a User Product, and the conveying occurs as part of a transaction in which the right of possession and use of the User Product is transferred to the recipient in perpetuity or for a fixed term (regardless of how the transaction is characterized), the Corresponding Source conveyed under this section must be accompanied by the Installation Information. But this requirement does not apply if neither you nor any third party retains the ability to install modified object code on the User Product (for example, the work has been installed in ROM).

The requirement to provide Installation Information does not include a requirement to continue to provide support service, warranty, or updates for a work that has been modified or installed by the recipient, or for the User Product in which it has been modified or installed. Access to a network may be denied when the modification itself materially and adversely affects the operation of the network or violates the rules and protocols for communication across the network.

Corresponding Source conveyed, and Installation Information provided, in accord with this section must be in a format that is publicly documented (and with an implementation available to the public in source code form), and must require no special password or key for unpacking, reading or copying.

## 7. Additional Terms.

“Additional permissions” are terms that supplement the terms of this License by making exceptions from one or more of its conditions. Additional permissions that are applicable to the entire Program shall be treated as though they were included in this License, to the extent that they are valid under applicable law. If additional permissions apply only to part of the Program, that part may be used separately under those permissions, but the entire Program remains governed by this License without regard to the additional permissions.

When you convey a copy of a covered work, you may at your option remove any additional permissions from that copy, or from any part of it. (Additional permissions may be written to require their own removal in certain cases when you modify the work.) You may place additional permissions on material, added by you to a covered work, for which you have or can give appropriate copyright permission.

Notwithstanding any other provision of this License, for material you add to a covered work, you may (if authorized by the copyright holders of that material) supplement the terms of this License with terms:

- a) Disclaiming warranty or limiting liability differently from the terms of sections 15 and 16 of this License; or
- b) Requiring preservation of specified reasonable legal notices or author attributions in that material or in the Appropriate Legal Notices displayed by works containing it; or
- c) Prohibiting misrepresentation of the origin of that material, or requiring that modified versions of such material be marked in reasonable ways as different from the original version; or
- d) Limiting the use for publicity purposes of names of licensors or authors of the material; or
- e) Declining to grant rights under trademark law for use of some trade names, trademarks, or service marks; or
- f) Requiring indemnification of licensors and authors of that material by anyone who conveys the material (or modified versions of it) with contractual assumptions of liability to the recipient, for any liability that these contractual assumptions directly impose on those licensors and authors.

All other non-permissive additional terms are considered “further restrictions” within the meaning of section 10. If the Program as you received it, or any part of it, contains a notice stating that it is governed by this License along with a term that is a further restriction, you may remove that term. If a license document contains a further restriction but permits relicensing or conveying under this License, you may add to a covered work material governed by the terms of that license document, provided that the further restriction does not survive such relicensing or conveying.

If you add terms to a covered work in accord with this section, you must place, in the relevant source files, a statement of the additional terms that apply to those files, or a notice indicating where to find the applicable terms.

Additional terms, permissive or non-permissive, may be stated in the form of a separately written license, or stated as exceptions; the above requirements apply either way.

## 8. Termination.

You may not propagate or modify a covered work except as expressly provided under this License. Any attempt otherwise to propagate or modify it is void, and will automatically terminate your rights under this License (including any patent licenses granted under the third paragraph of section 11).

However, if you cease all violation of this License, then your license from a particular copyright holder is reinstated (a) provisionally, unless and until the copyright holder explicitly and finally terminates your license, and (b) permanently, if the copyright holder fails to notify you of the violation by some reasonable means prior to 60 days after the cessation.

Moreover, your license from a particular copyright holder is reinstated permanently if the copyright holder notifies you of the violation by some reasonable means, this is the first time you have received notice of violation of this License (for any work) from that copyright holder, and you cure the violation prior to 30 days after your receipt of the notice.

Termination of your rights under this section does not terminate the licenses of parties who have received copies or rights from you under this License. If your rights have been terminated and not permanently reinstated, you do not qualify to receive new licenses for the same material under section 10.

#### 9. Acceptance Not Required for Having Copies.

You are not required to accept this License in order to receive or run a copy of the Program. Ancillary propagation of a covered work occurring solely as a consequence of using peer-to-peer transmission to receive a copy likewise does not require acceptance. However, nothing other than this License grants you permission to propagate or modify any covered work. These actions infringe copyright if you do not accept this License. Therefore, by modifying or propagating a covered work, you indicate your acceptance of this License to do so.

#### 10. Automatic Licensing of Downstream Recipients.

Each time you convey a covered work, the recipient automatically receives a license from the original licensors, to run, modify and propagate that work, subject to this License. You are not responsible for enforcing compliance by third parties with this License.

An “entity transaction” is a transaction transferring control of an organization, or substantially all assets of one, or subdividing an organization, or merging organizations. If propagation of a covered work results from an entity transaction, each party to that transaction who receives a copy of the work also receives whatever licenses to the work the party's predecessor in interest had or could give under the previous paragraph, plus a right to possession of the Corresponding Source of the work from the predecessor in interest, if the predecessor has it or can get it with reasonable efforts.

You may not impose any further restrictions on the exercise of the rights granted or affirmed under this License. For example, you may not impose a license fee, royalty, or other charge for exercise of rights granted under this License, and you may not initiate litigation (including a cross-claim or counterclaim in a lawsuit) alleging that any patent claim is infringed by making, using, selling, offering for sale, or importing the Program or any portion of it.

#### 11. Patents.

A “contributor” is a copyright holder who authorizes use under this License of the Program or a work on which the Program is based. The work thus licensed is called the contributor's “contributor version”.

A contributor's “essential patent claims” are all patent claims owned or controlled by the contributor, whether already acquired or hereafter acquired, that would be infringed by some manner, permitted by this License, of making, using, or selling its contributor version, but do not include claims that would be infringed only as a consequence of further modification of the contributor version. For purposes of this definition, “control” includes the right to grant patent sublicenses in a manner consistent with the requirements of this License.

Each contributor grants you a non-exclusive, worldwide, royalty-free patent license under the contributor's essential patent claims, to make, use, sell, offer for sale, import and otherwise run, modify and propagate the contents of its contributor version.

In the following three paragraphs, a “patent license” is any express agreement or commitment, however denominated, not to enforce a patent (such as an express permission to practice a patent or covenant not to sue for patent infringement). To “grant” such a patent license to a party means to make such an agreement or commitment not to enforce a patent against the party.

If you convey a covered work, knowingly relying on a patent license, and the Corresponding Source of the work is not available for anyone to copy, free of charge and under the terms of this License, through a publicly available network server or other readily accessible means, then you must either (1) cause the Corresponding Source to be so available, or (2) arrange to deprive yourself of the benefit of the patent license for this particular work, or (3) arrange, in a manner consistent with the requirements of this License, to extend the patent license to downstream recipients. “Knowingly relying” means you have actual knowledge that, but for the patent license, your conveying the covered work in a country, or your recipient's use of the covered work in a country, would infringe one or more identifiable patents in that country that you have reason to believe are valid.

If, pursuant to or in connection with a single transaction or arrangement, you convey, or propagate by procuring conveyance of, a covered work, and grant a patent license to some of the parties receiving the covered work authorizing them to use, propagate, modify or convey a specific

copy of the covered work, then the patent license you grant is automatically extended to all recipients of the covered work and works based on it.

A patent license is “discriminatory” if it does not include within the scope of its coverage, prohibits the exercise of, or is conditioned on the non-exercise of one or more of the rights that are specifically granted under this License. You may not convey a covered work if you are a party to an arrangement with a third party that is in the business of distributing software, under which you make payment to the third party based on the extent of your activity of conveying the work, and under which the third party grants, to any of the parties who would receive the covered work from you, a discriminatory patent license (a) in connection with copies of the covered work conveyed by you (or copies made from those copies), or (b) primarily for and in connection with specific products or compilations that contain the covered work, unless you entered into that arrangement, or that patent license was granted, prior to 28 March 2007.

Nothing in this License shall be construed as excluding or limiting any implied license or other defenses to infringement that may otherwise be available to you under applicable patent law.

#### 12. No Surrender of Others' Freedom.

If conditions are imposed on you (whether by court order, agreement or otherwise) that contradict the conditions of this License, they do not excuse you from the conditions of this License. If you cannot convey a covered work so as to satisfy simultaneously your obligations under this License and any other pertinent obligations, then as a consequence you may not convey it at all. For example, if you agree to terms that obligate you to collect a royalty for further conveying from those to whom you convey the Program, the only way you could satisfy both those terms and this License would be to refrain entirely from conveying the Program.

#### 13. Use with the GNU Affero General Public License.

Notwithstanding any other provision of this License, you have permission to link or combine any covered work with a work licensed under version 3 of the GNU Affero General Public License into a single combined work, and to convey the resulting work. The terms of this License will continue to apply to the part which is the covered work, but the special requirements of the GNU Affero General Public License, section 13, concerning interaction through a network will apply to the combination as such.

#### 14. Revised Versions of this License.

The Free Software Foundation may publish revised and/or new versions of the GNU General Public License from time to time. Such new versions will be similar in spirit to the present version, but may differ in detail to address new problems or concerns.

Each version is given a distinguishing version number. If the Program specifies that a certain numbered version of the GNU General Public License “or any later version” applies to it, you have the option of following the terms and conditions either of that numbered version or of any later version published by the Free Software Foundation. If the Program does not specify a version number of the GNU General Public License, you may choose any version ever published by the Free Software Foundation.

If the Program specifies that a proxy can decide which future versions of the GNU General Public License can be used, that proxy's public statement of acceptance of a version permanently authorizes you to choose that version for the Program.

Later license versions may give you additional or different permissions. However, no additional obligations are imposed on any author or copyright holder as a result of your choosing to follow a later version.

#### 15. Disclaimer of Warranty.

THERE IS NO WARRANTY FOR THE PROGRAM, TO THE EXTENT PERMITTED BY APPLICABLE LAW. EXCEPT WHEN OTHERWISE STATED IN WRITING THE COPYRIGHT HOLDERS AND/OR OTHER PARTIES PROVIDE THE PROGRAM “AS IS” WITHOUT WARRANTY OF ANY KIND, EITHER EXPRESSED OR IMPLIED, INCLUDING, BUT NOT LIMITED TO, THE IMPLIED WARRANTIES OF MERCHANTABILITY AND FITNESS FOR A PARTICULAR PURPOSE. THE ENTIRE RISK AS TO THE QUALITY AND PERFORMANCE OF THE PROGRAM IS WITH YOU. SHOULD THE PROGRAM PROVE DEFECTIVE, YOU ASSUME THE COST OF ALL NECESSARY SERVICING, REPAIR OR CORRECTION.

#### 16. Limitation of Liability.

IN NO EVENT UNLESS REQUIRED BY APPLICABLE LAW OR AGREED TO IN WRITING WILL ANY COPYRIGHT HOLDER, OR ANY OTHER PARTY WHO MODIFIES AND/OR CONVEYS THE PROGRAM AS PERMITTED ABOVE, BE LIABLE TO YOU FOR DAMAGES, INCLUDING ANY GENERAL, SPECIAL, INCIDENTAL OR CONSEQUENTIAL DAMAGES ARISING OUT OF THE USE OR INABILITY TO USE THE PROGRAM (INCLUDING BUT NOT LIMITED TO LOSS OF DATA OR DATA BEING RENDERED INACCURATE OR LOSSES SUSTAINED BY YOU OR THIRD PARTIES OR A FAILURE OF THE PROGRAM TO OPERATE WITH ANY OTHER PROGRAMS), EVEN IF SUCH HOLDER OR OTHER PARTY HAS BEEN ADVISED OF THE POSSIBILITY OF SUCH DAMAGES.

#### 17. Interpretation of Sections 15 and 16.

If the disclaimer of warranty and limitation of liability provided above cannot be given local legal effect according to their terms, reviewing courts shall apply local law that most closely approximates an absolute waiver of all civil liability in connection with the Program, unless a warranty or assumption of liability accompanies a copy of the Program in return for a fee.

#### END OF TERMS AND CONDITIONS

#### How to Apply These Terms to Your New Programs

If you develop a new program, and you want it to be of the greatest possible use to the public, the best way to achieve this is to make it free software which everyone can redistribute and change under these terms.

To do so, attach the following notices to the program. It is safest to attach them to the start of each source file to most effectively state the exclusion of warranty; and each file should have at least the “copyright” line and a pointer to where the full notice is found.

<one line to give the program's name and a brief idea of what it does.>

Copyright (C) <year> <name of author>

This program is free software: you can redistribute it and/or modify

it under the terms of the GNU General Public License as published by

the Free Software Foundation, either version 3 of the License, or

(at your option) any later version.

This program is distributed in the hope that it will be useful,

but WITHOUT ANY WARRANTY; without even the implied warranty of

MERCHANTABILITY or FITNESS FOR A PARTICULAR PURPOSE. See the

GNU General Public License for more details.

You should have received a copy of the GNU General Public License

along with this program. If not, see <<https://www.gnu.org/licenses/>>.

Also add information on how to contact you by electronic and paper mail.

If the program does terminal interaction, make it output a short notice like this when it starts in an interactive mode:

<program> Copyright (C) <year> <name of author>

This program comes with ABSOLUTELY NO WARRANTY; for details type `show w'.

This is free software, and you are welcome to redistribute it

under certain conditions; type `show c' for details.

The hypothetical commands `show w' and `show c' should show the appropriate parts of the General Public License. Of course, your program's commands might be different; for a GUI interface, you would use an “about box”.

You should also get your employer (if you work as a programmer) or school, if any, to sign a “copyright disclaimer” for the program, if necessary. For more information on this, and how to apply and follow the GNU GPL, see <<https://www.gnu.org/licenses/>>.

The GNU General Public License does not permit incorporating your program into proprietary programs. If your program is a subroutine library, you may consider it more useful to permit linking proprietary applications with the library. If this is what you want to do, use the GNU Lesser General Public License instead of this License. But first, please read <<https://www.gnu.org/licenses/why-not-lgpl.html>>.

e. Contact information

For any questions regarding the license terms, obtaining the source code, or any other inquiries, please contact us at:

Olliter Laboratory SAgl

Amsler 1,

CH-7304 Maienfeld

Or, via email at the following address:

[legal@olliter.com](mailto:legal@olliter.com)

### 3. Hardware license

The hardware component of this product, including the SDR device and all related hardware accessories, is 100% proprietary to Olliter SAgL. It has been designed and developed independently and is not derived from or inspired by any other SDR devices. All rights to the hardware design and implementation are reserved.

The use of the hardware is subject to Olliter SAgL proprietary hardware terms and conditions, which can be found in the hardware documentation provided with this product.

#### a. Hardware terms and conditions

These Hardware Terms and Conditions ("Agreement") govern the use of the hardware provided by Olliter SAgL ("Company"), including but not limited to the Olliter SDR ("Hardware"). By using the Hardware, you agree to be bound by the terms of this Agreement.

#### b. License grant

Olliter SAgL grants you a non-exclusive, non-transferable, limited right to use the Hardware solely for its intended purpose as specified in the accompanying documentation.

#### c. Intellectual property rights

All intellectual property rights in and to the Hardware, including design, development, and any associated documentation, are owned by Olliter SAgL. This Agreement does not grant you any rights to the Company's intellectual property except as expressly set forth herein.

#### d. Restrictions

By using the Olliter SDR transceiver, you agree not to:

- Reverse engineer, decompile, or disassemble the Hardware.
- Modify, adapt, or create derivative works based on the Hardware.
- Rent, lease, loan, or distribute the Hardware to any third party.
- Remove or alter any proprietary notices or labels on the Hardware.

#### e. Warranty disclaimer

The Hardware is provided "AS IS" and "AS AVAILABLE," without warranty of any kind, express or implied, including but not limited to the implied warranties of merchantability, fitness for a particular purpose, and non-infringement. Olliter SAgL does not warrant that the Hardware will meet your requirements or that its operation will be uninterrupted or error-free.

Hardware-related issues shall be reported to [hello@olliter.com](mailto:hello@olliter.com).



#### f. Limitation of Liability

To the maximum extent permitted by applicable law, in no event shall Olliter SAgl be liable for any indirect, incidental, special, consequential, or punitive damages, or any loss of profits or revenues, whether incurred directly or indirectly, or any loss of data, use, goodwill, or other intangible losses, resulting from:

- Your use or inability to use the Hardware.
- Any unauthorized access to or use of the Hardware.
- Any alteration of your data.
- Any other matter related to the Hardware.

#### g. Indemnification

You agree to indemnify, defend, and hold harmless Olliter SAgl from and against any and all claims, liabilities, damages, losses, and expenses, including reasonable attorneys' fees and costs, arising out of or in any way connected with your use of the Hardware or violation of this Agreement.

#### h. Termination

This Agreement is effective until terminated by either party. Your rights under this Agreement will terminate automatically without notice if you fail to comply with any terms of this Agreement. Upon termination, you must cease all use of the Hardware and destroy all copies of any accompanying documentation.

#### i. Governing Law

This Agreement shall be governed by and construed in accordance with the laws of Switzerland, without regard to its conflict of law principles. Any legal actions or proceedings arising out of or related to this Agreement shall be brought exclusively in the courts located in Switzerland.

#### j. Entire Agreement

This Agreement constitutes the entire agreement between you and Olliter SAgl regarding the use of the Hardware and supersedes all prior or contemporaneous understandings and agreements, whether written or oral, regarding such subject matter.

#### k. Amendments

Olliter SAgl reserves the right to amend this Agreement at any time by providing notice to you. Your continued use of the Hardware after any such amendments shall constitute your acceptance of the amended terms.

l. Contact information

If you have any questions about this hardware agreement, please contact:

*Olliter Laboratory SAgI*

*Amsler 1,*

*CH-7304 Maienfeld*

Or, via email at the following address:

[legal@olliter.com](mailto:legal@olliter.com)

#### 4. Introduction

The main purpose of this guide is to help you configuring for the first time your Olliter SDR Transceiver.

This guide may not fully cover the hardware configuration of the device or every feature available on the software, it will cover the first steps to receive and transmit with your device.

#### 5. Device overview

This chapter covers the input and output of the Olliter SDR transceiver to guide the user when interfacing with external devices.

a. Front panel

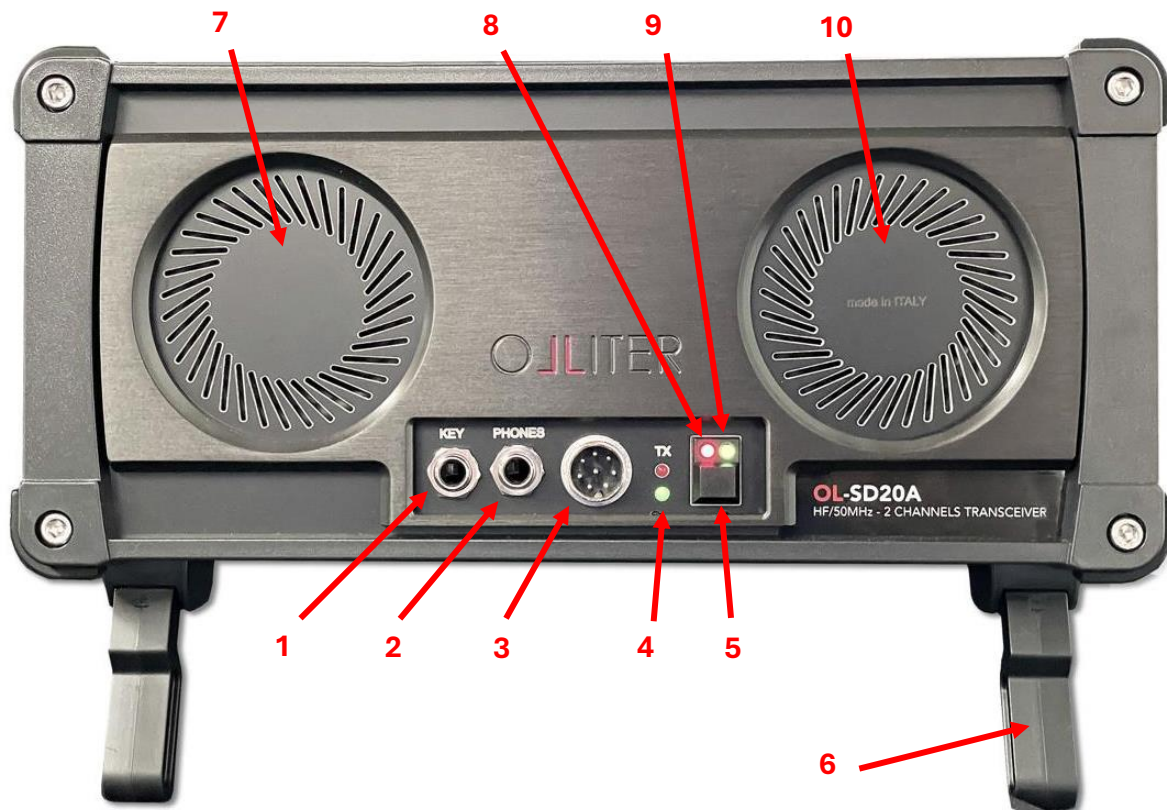

1. Morse key input
2. Headphones output
3. Microphone input
4. Connection LED
5. Power button
6. Adjustable legs
7. Left speaker
8. Standby LED
9. Power-on LED
10. Right speaker

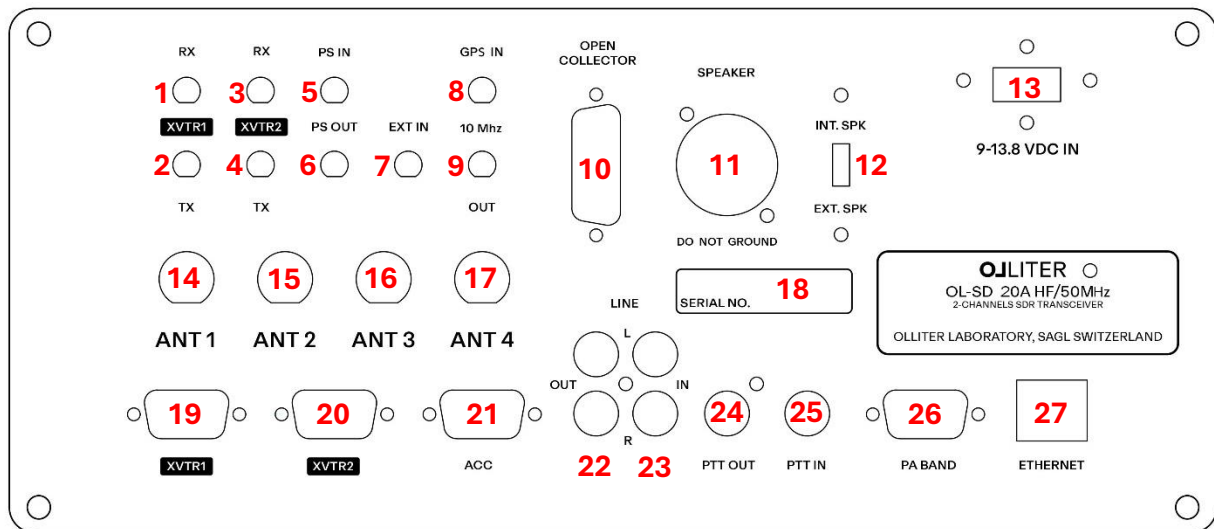
**b. Back panel**

1. Receiving line for the transverter interface 1
2. Transmitting line for the transverter interface 1
3. Receiving line for the transverter interface 2
4. Transmitting line for the transverter interface 2
5. Pure signal input
6. Pure signal output
7. EXT IN (unfiltered RF input)
8. 10MHz input from an external oscillator (GPSDO or rubidium reference)
9. 10MHz output for external devices (such as transverters)
10. Open collector I/O (can be configured from OL-Master)
11. Speaker connection (high power output, designed for external 8-ohm speakers)
12. Internal or external speaker selector
13. Power supply input (13.8V DC)
14. Antenna 1 receiving and transmitting connector
15. Antenna 2 receiving and transmitting connector
16. Antenna 3 receiving and transmitting connector
17. Antenna 4 receiving and transmitting connector
18. Serial number location
19. Transverter 1 interface (digital inputs and outputs to control external transverters)
20. Transverter 2 interface (digital inputs and outputs to control external transverters)
21. External accessories interface (digital inputs and outputs)
22. RCA audio output (low power output, to be sent to the line-in of external audio devices)
23. RCA audio input (low power input, to be used as transmitting audio line)
24. Open collector PTT output
25. External PTT input (active low)
26. Band output (digital output)
27. Ethernet interface (1Gbps only)

### c. Connectors description

Here is a description of the inputs and outputs of the Olliter SDR transceiver. Some of these connections are highly sensitive to ESD, overvoltage, short-circuit, overcurrent and more, please take all the recommended measures when connecting external devices.



The warranty for your Olliter SDR device will be voided if our customer assistance department determines that the device has been damaged or rendered inoperative due to improper connection of external devices.



The warranty for your Olliter SDR will be voided if our customer assistance department determines that the device has been damaged or rendered inoperative due to the connection of external devices that generate or absorb excessive current or voltage.

#### - Morse key jack

This ¼ inch (6.35mm) jack is used to connect either a paddle or a straight key. When using a paddle, the DOT and DASHES can be swapped from the CW menu of OL-Master settings.

This connector uses either 5V or 3V3 pull-up resistors. Voltage can be selected by moving the internal “3.3 – 5V I/O” jumper.

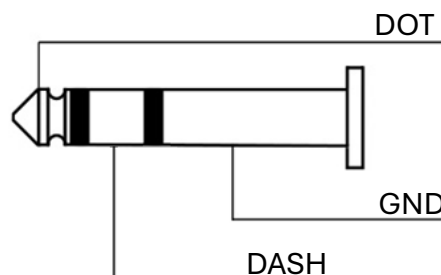
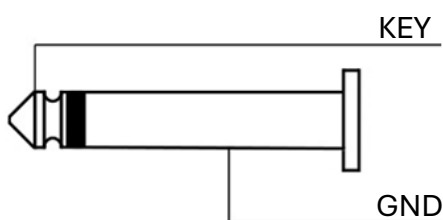

- Headphones output

This output is designed to drive standard headphones with a nominal impedance of 16Ω impedance, output level is 50mW for a -75dB THD.



Prolonged use of headphones at high volume can cause permanent hearing damage. Adjust the volume to a safe level to protect your ears

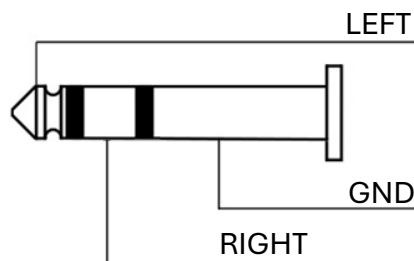

- Microphone input

This input should be chosen when placing the order for the Olliter SDR transceiver. This input is designed to work with either Icom (such as the SM-30) or Yaesu (such as M-70) microphones.



If the transceiver was ordered with a Icom wiring, a Yaesu microphone cannot be used and vice versa. Using a different microphone style can damage the transceiver and/or the microphone.

In addition to the microphone wiring that was requested, and independently from the user choice, a balanced input for a dynamic capsule is also available on the same connector.

Selection between 5V, 8V or none can be toggled in the Setup menu of OL-Master.



Before connecting any kind of microphone to the transceiver, please adjust the voltage settings in the Setup menu of OL-Master software. Incorrect voltage settings may damage the transceiver and/or the microphone.

Advanced features (like up/down, scan, etc.) are not available.

Transceiver that was ordered with Icom wiring		
Pin	Icom SM-30	Dynamic microphone
1	Microphone signal	Balanced input +
2	+8V microphone power	N.C.
3	N.C.	N.C.
4	N.C.	Balanced input -
5	PTT signal	PTT signal
6	PTT GND	PTT GND
7	Microphone GND	GND
8	N.C.	N.C.

Transceiver that was ordered with Yaesu wiring		
Pin	Yaesu M-70	Dynamic microphone
1	N.C.	N.C.
2	+5V microphone power	N.C.
3	N.C.	N.C.
4	N.C.	Balanced input -
5	PTT GND	PTT GND
6	PTT Signal	PTT Signal
7	Microphone GND	GND
8	Microphone signal	Balanced input +

Icom and the Icom logo are registered trademarks of Icom Incorporated (Japan)

Yaesu and the Yaesu logo are registered trademarks of Yaesu Musen Co., Ltd.



## - Front panel LEDs

The front panel offers four different LEDs, each LED have a different meaning



1. Connection status: this LED is ON when OL-Master is communicating with the transceiver
2. Transmission: this LED is ON when the device is transmitting
3. Stand-by: this LED is ON when voltage is applied to the device
4. Power-on: this LED is ON when the power button is pressed and stays on when the device is operating (even if not communicating with OL-Master)

If the Power-on LED is not turning on when pressing the power button, please refer to the Troubleshooting chapter of this manual

## - Front speakers

These speakers are controlled by OL-Master and can be used to play the demodulated signal that is tuned. The onboard speakers can be enabled or disabled from OL-Master, volume control is also provided by the software

## - Transverter interfaces

The transverter input and outputs are designed to drive external devices to provide additional bands to the transceiver.

The transverter input 1 is connected to the CH1 line of the SDR, while the transverter input 2 is connected to the CH2 line of the SDR. Both inputs are passed through a dedicated 50MHz low-pass filter, a 32dB software-controlled attenuator and a 20dB amplifier. The suggested maximum input should be -2dBm (assuming no attenuator is used).

The nominal output for the transverter transmission line is 10dBm, this value may vary a little depending on the IF frequency that is configured. The transmission signal is passed through a 50MHz low-pass filter, and a programmable attenuator (which is controlled by the TX Power slider in OL-Master).

Transverters can be configured using the dedicated section of the OL-Master software.

- EXT IN

This input provides an unfiltered path to the CH2 line of the transceiver, it is typically used to interface with external devices where filters are already installed (such as panadapter interfaces).

- 10MHz references

The Olliter SDR transceiver can be connected to an external 10MHz reference to provide better frequency stability, this is very convenient when working with high-frequency devices like microwave transverters.

The 10MHz input (labelled as GPS IN) is a 50Ω input between -15dBm and +5dBm. This input is protected against overvoltage but using an attenuator (if needed) is recommended.

The 10MHz output (labelled as OUT) provides a 3.3V CMOS output with a series resistance (used as short-circuit protection). This output can only be used as a frequency reference, and it was not designed to provide more than 20mA. This output comes from the internal TCXO when no external reference is applied.

- PA Band connector

This connector offers some digital outputs that can be used to drive external antenna switches or amplifiers.

These outputs can be programmed by the user using the Setup menu of OL-Master.

These outputs are normally in a LOW state using a pull-down resistor.

The voltage that is provided by this port depends on the internal “3.3 – 5V I/O” jumper. Maximum available current is limited with a 220Ω series resistor.

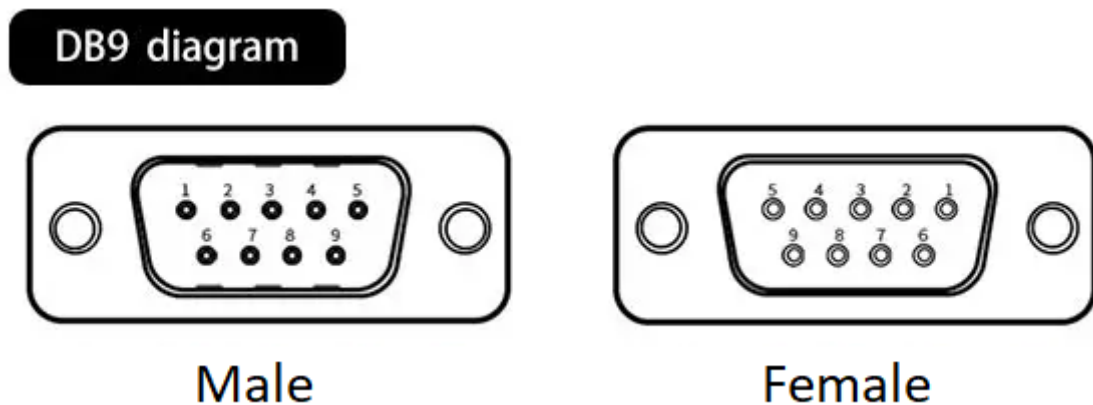

DB9 Pin	Software output
1	Digital out 1
2	Digital out 2
3	Digital out 3
4	Digital out 4
5	GND
6	Digital out 5
7	Digital out 6
8	Digital out 7
9	Digital out 8

- ACC connector

This connector offers some inputs to control several features of the SDR, such as PTT controls for RX2, RX3 and RX4, an external inhibit line, and two additional analog inputs that can be used to get information from external devices (like temperature probes or flow meters).

The voltage that can be applied to the digital input port depends on the internal “3.3 – 5V I/O” jumper. In any case, it should never exceed the configured voltage.

	3.3V I/O	5V I/O
Low state	0V to 0.8V	0V to 1.5V
High state	2V to 3.3V	3.5V to 5V

The voltage range for both ADC0 and ADC1 is 0V to 3.3V. Excessive voltage can cause severe damage to the ADC circuitry.

Pins 6 and 8 have an internal 4.7KΩ pull-up resistor, while pins 7 and 9 have an internal 4.7KΩ pull-down resistor.

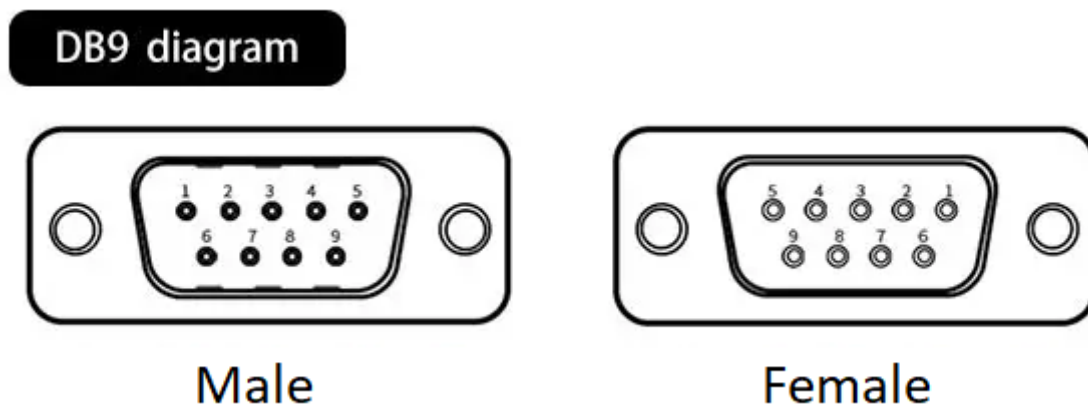

DB9 Pin	Software output
1	GND
2	N.C.
3	ADC in 1
4	ADC in 0
5	GND
6	PTT RX2 (active LOW)
7	PTT RX4 (active HIGH)
8	PTT RX3 (active LOW)
9	Ext Inhibit (active HIGH)

- OC connector

This connector offers 8 open-collector outputs that can be used to drive external accessories like power amplifiers or antenna relays.

The maximum  $V_{CE}$  that can be used at the open-collector outputs is 48V DC.

The 13.8V DC lines are derived from the main power supply and are protected by a 250mA resettable fuse.

**DB15 diagram**

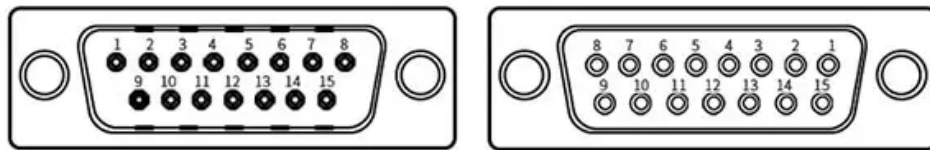

**Male**

**Female**

DB15 Pin	Software output
1	GND
2	OUT 2
3	OUT 4
4	OUT 6
5	OUT 8
6	GND
7	GND
8	13.8V
9	OUT 1
10	OUT 3
11	OUT 5
12	OUT 7
13	Open-collector common
14	GND
15	13.8V

External relay connection example:

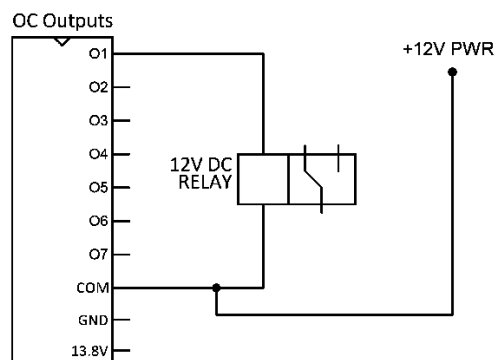

- Power connector

Please refer to the Connecting the power supply chapter for further information

- Antenna connectors

These four BNC connectors are used by the transceiver to receive and transmit. Different bands can receive or transmit on different antennas, mapping between bands, mode and antenna can be done in the Setup menu of OL-Master.

Please refer to the Connecting the antenna for further information

## 6. System requirements

An SDR transceiver requires a control device to work, the hardware of the transceiver is used to convert analog RF signals to an IQ stream that is sent to a software installed on the control device, where it is processed to extract an audio signal. When transmitting, the process is reversed. The hardware and software need to work together to receive and transmit signals using the SDR transceiver.

Some I/O are available on-board to interface with external accessories like microphones, headphones and Morse key or paddle.

A simplified schematic representation of the SDR device is shown below.

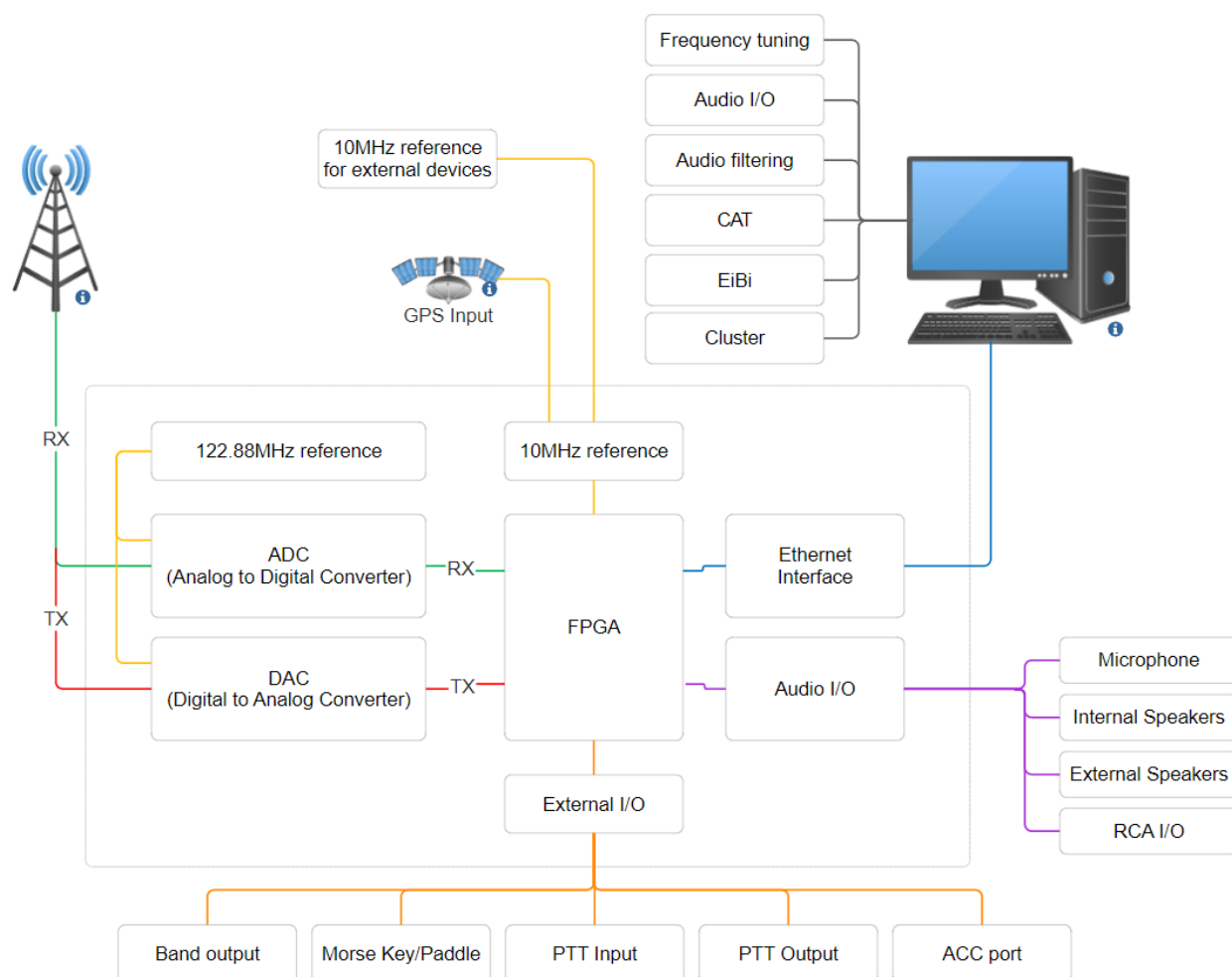

#### a. Software requirements

As any SDR device, one of the main components is the PC that is used to control the device, the same PC is also used to decode and process the raw digital stream of data to usable audio stream. This decode process requires some minimum software and hardware requirements that should be met.

##### - Operating system requirements

The OL-Master application was developed for Microsoft Windows 10 or later. Virtualization of such operating systems is also supported, if the host machine is capable enough.

Compatibility with Microsoft Windows 8.1 or previous versions of Microsoft Windows cannot be ensured due to lack of support for .NET Framework 4.8.1 which was used to develop the application.

##### - .NET Framework requirements

The operating system should be updated to the latest version and the .NET Framework 4.8.1 must be installed on the machine (latest update of the .NET Framework can be downloaded from the following URL <https://dotnet.microsoft.com/en-us/download/dotnet-framework/net481>).

##### - Microsoft Visual C++ Redistributable

Some components of the software were written using highly optimized C++ code, this requires the latest version of the Microsoft Visual C++ Redistributable package to be installed and updated. The latest version of this package can be downloaded from the following URL: <https://learn.microsoft.com/it-it/cpp/windows/latest-supported-vc-redist?view=msvc-170> .

As per the moment this manual was written, the latest available version is 14.40.33810.0.

#### b. Hardware requirements

Recommended hardware setup is an 7<sup>th</sup> generation Intel Core I5 or later, with at least 16GB of RAM and 1GB of available storage space (disk usage may vary depending on additional features like recordings, cluster, EIBI and more).

Ethernet interface at 1Gbps on the control PC is mandatory if using more than one receiver window. Ethernet interface at 1Gbps is mandatory to configure the IP address of the device if connected directly to the control PC.



c. Network requirements

An ethernet interface capable of 1Gbps is mandatory for the transceiver to communicate with the control device (PC), a properly configured ethernet switch with interfaces at 1Gbps is suggested to be used in between the SDR and the PC.

Please note, the transceiver does not support negotiating any speed lower than 1Gbps with the control device or the switch/router that is plugged into.

An ethernet cable CAT5 or superior is highly recommended to interface the SDR to the switch/router and the PC.

To ensure best performances, use high quality switch or router and cables, make sure the whole network from the SDR to the master PC is capable of continuously communicate at 1Gbps.

An internet connection is not required if not using external services (like clusters or EIBI).

A network connection diagram is available at the Sample Ethernet connection. chapter.

## 7. Installing OL-Master

After buying an Olliter SDR, you should receive the setup file for OL-Master, this is the main application that controls the SDR and must be installed on the PC.



Double click the executable to start the installer, administrative privileges are mandatory to install the software. Follow the on-screen instructions to proceed with the installation.

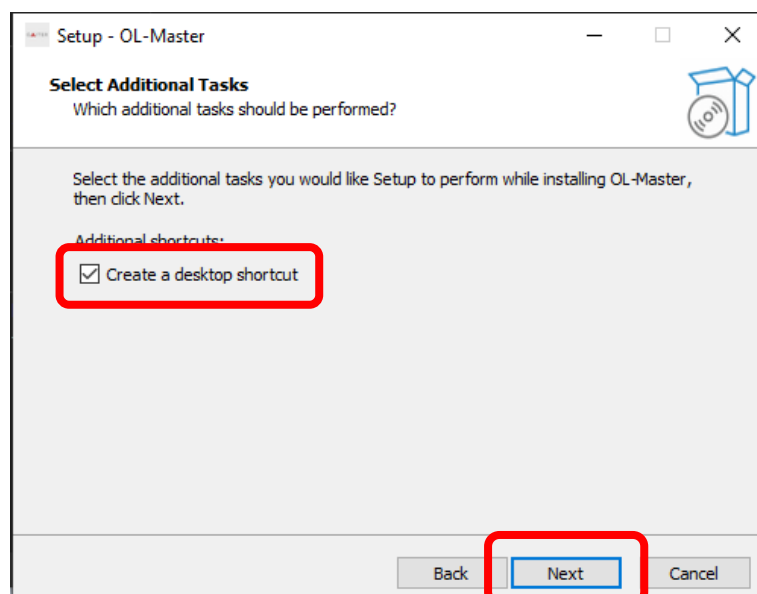
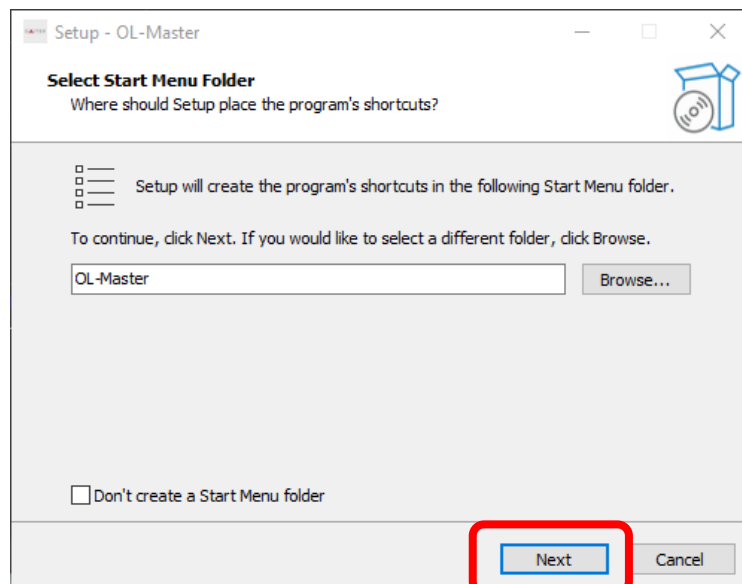

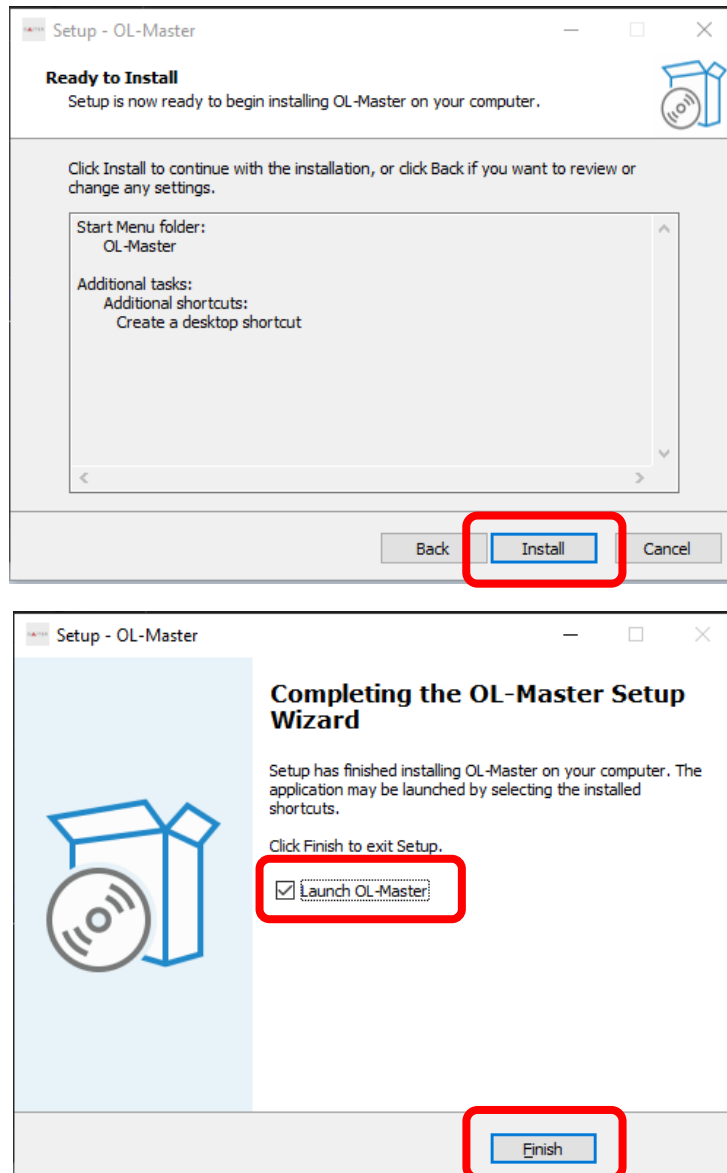

Setup is now completed, before starting the software, please read carefully the next chapter.

## 8. Wiring the transceiver

Connecting the transceiver is simple but a couple of considerations and safety measures are needed, please read carefully the wiring instructions to prevent damages to the Olliter SDR.

Electrostatic Discharge (ESD) can cause severe damage to electrical circuits, potentially leading to costly repairs or replacements. Always take measures to protect your equipment. These safety measures include but are not limited to:



- Proper Grounding: Make sure all equipment and workstations are properly grounded.
- Avoid Static-Inducing Clothing: Avoid wearing synthetic materials that generate static electricity.
- Handle Components with Care: Touch components only by their edges and avoid touching pins and circuitry.

a. Connecting of the PureSignal cable

To achieve optimal transmission quality and reduce the spurious emissions, the Pure Signal technology is supported by the Olliter SDR transceiver.

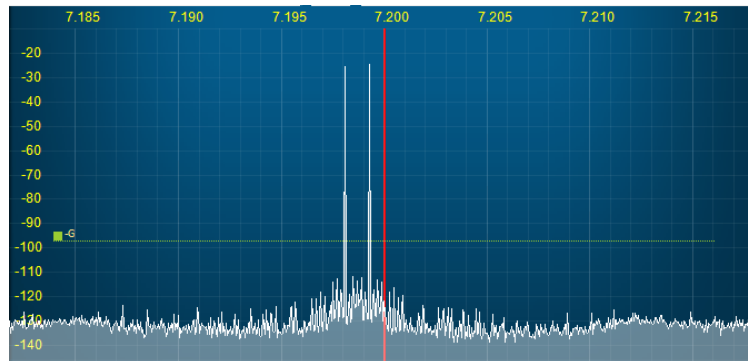

Pure Signal is the name given to the theory and implementation of the clean transmission logic developed by the OpenHPSDR team and implemented in both the Olliter SDR software and transceiver. The algorithm behind the Pure Signal technology is quite simple, when both the drive applied to the Digital-to-analogue converter (DAC) and the output as measured at the antenna are known it is possible to modify the drive so that the output is as clean as possible.

The Pure Signal technology is enabled by connecting the PS IN with the PS OUT using the provided SMA to SMA coaxial cable.



### b. Connecting the power supply

The Olliter SDR was designed to operate from a stable and constant power supply which is capable of continuously delivering 13.8V at 5A for the 20W model.

An integrated protection circuit is added to the transceiver which can help in protecting the radio from excessive voltage fluctuations by cutting the power line and turning off the device.



The integrated protection circuit should not be considered a surge, lightning or electrostatic protection, it was designed to protect the circuitry from excessive or low voltages which may negatively impact the transceiver performances.

Connect the power supply to the Olliter SDR by using high-quality Anderson PowerPole® connectors. Wire size should be chosen according to the length of the connection, here are our suggestions:

- Wires shorter than 2 meters (6.5ft) long will require 2mm<sup>2</sup> (AWG14) wires
- Wires between 2 and 4 meters (6.5ft to 13ft) will require 4mm<sup>2</sup> wires
- Wires longer than 4 meters (13ft) are not recommended as they may pick up excessive noise from the surrounding environment or cause excessive voltage fluctuations



Make sure to connect all the needed wires before turning on the power supply.

If the transceiver does not show the red (standby) light after applying power, please refer to the Troubleshooting chapter.

c. Connecting the antenna

Up to 4 antennas can be connected to the Olliter SDR, these can be configured in software to allow receiving and transmitting on different bands with different antennas.

To begin, connect an antenna using a male BNC connector to the ANT1 socket.



d. Ethernet connection

To interface the transceiver with the local network, please refer to the Connection of the SDR to the PC chapter of this manual.

e. Connecting the microphone

Each device comes with a dedicated microphone wiring which should be selected when ordering the transceiver, use the front 8-pin socket to connect the microphone.



## 9. Configuring the firewall

Network communication to the device is performed using UDP protocol, a security system exception must be created for the software to work reliably.

Open the Windows firewall settings.

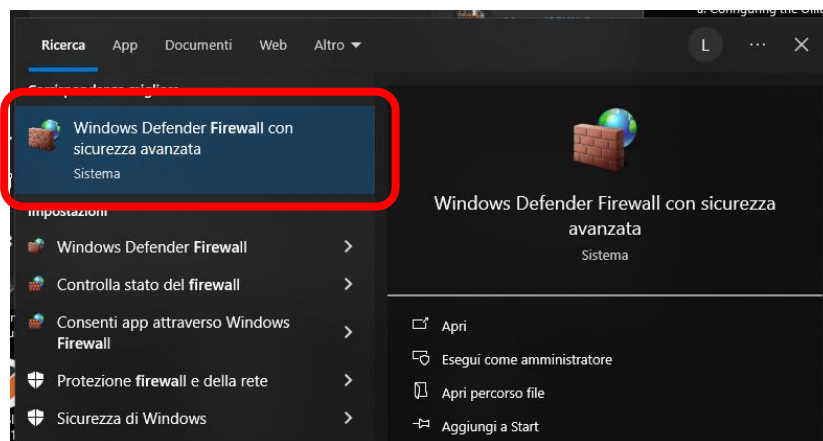

Select “Inbound connection rules” on the left menu.

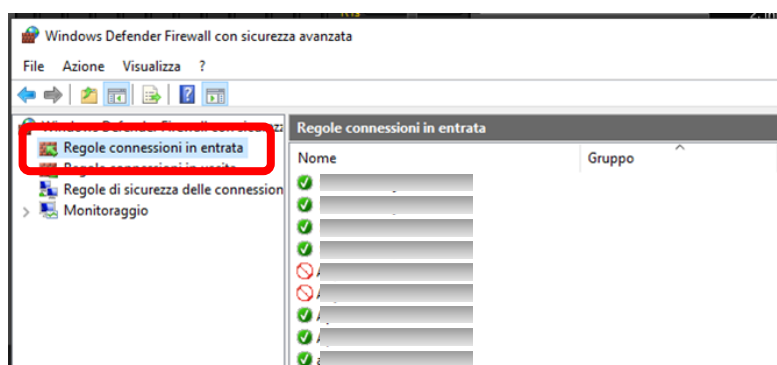

Click on “New rule” on the right menu.

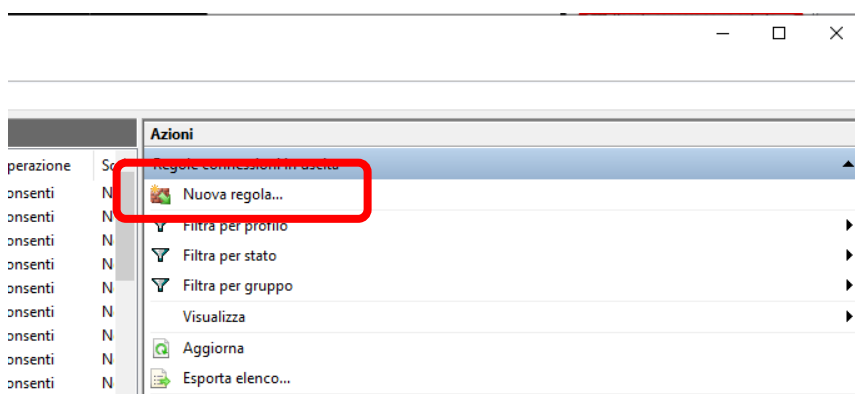

Select "Program" and click "next".

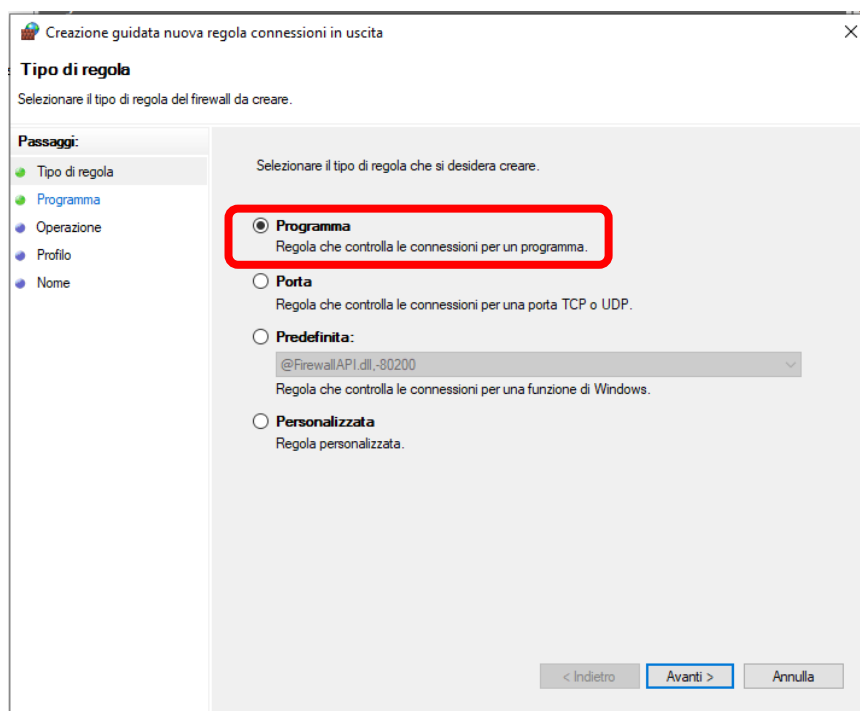

Click on "Browse" and navigate to "C:\Program Files\Olliter\Ol-master.exe"

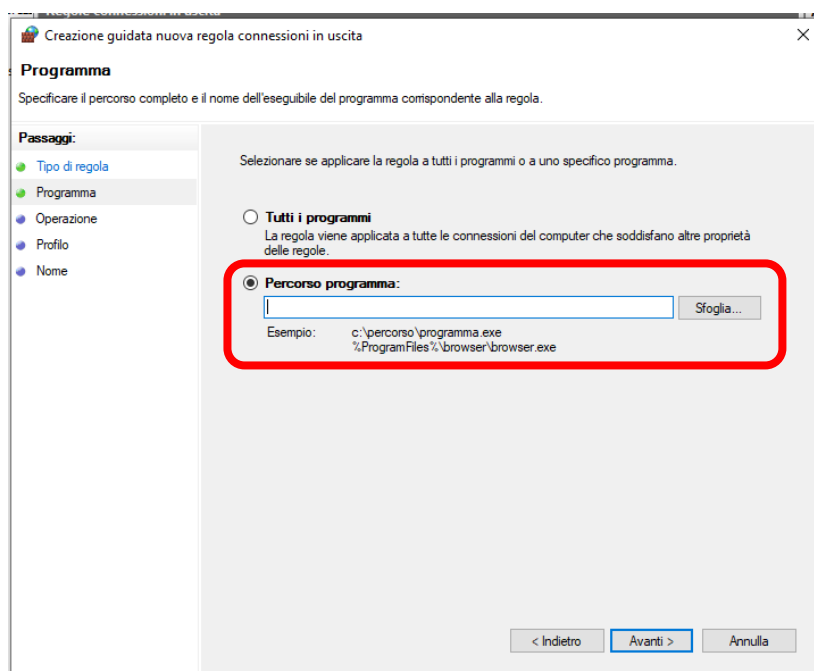

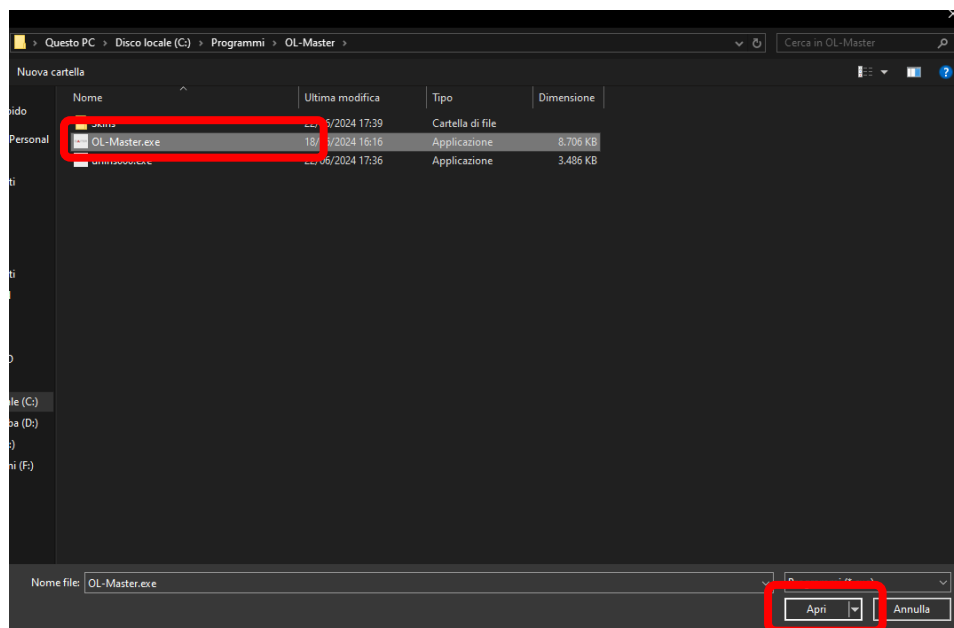

Click on "Next"

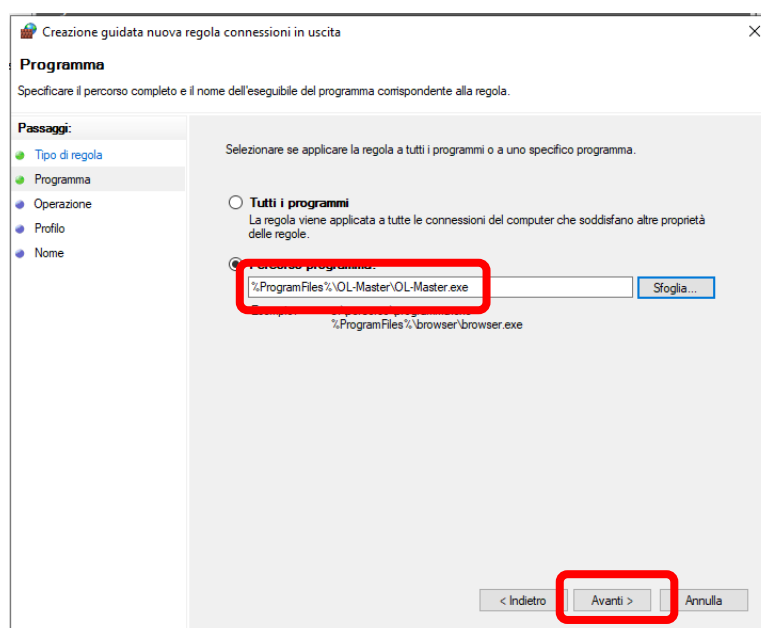

Select “Allow connections” and click “Next”.

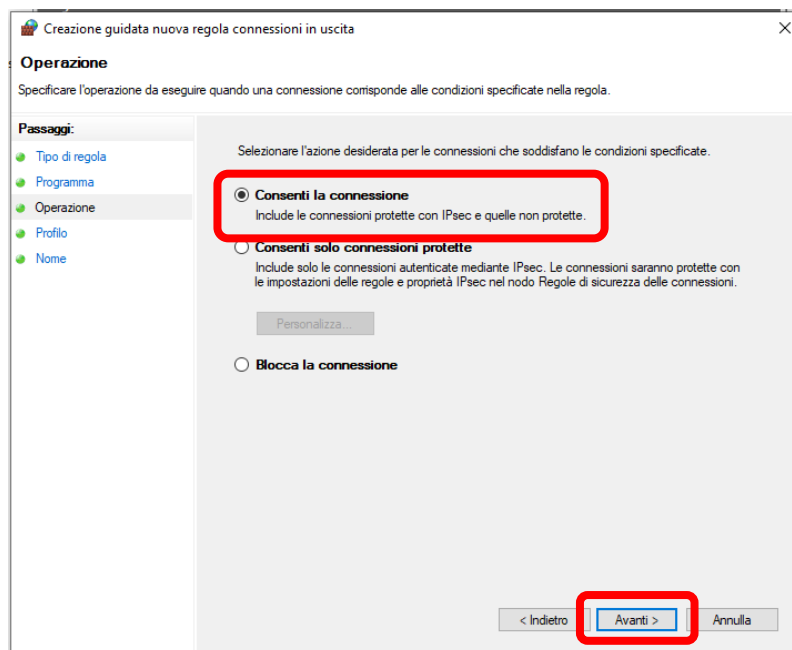

Now select the kind of network that you are using, by default it should be “Private”, if you are using a different kind of network, please select the option that best fits your configuration.

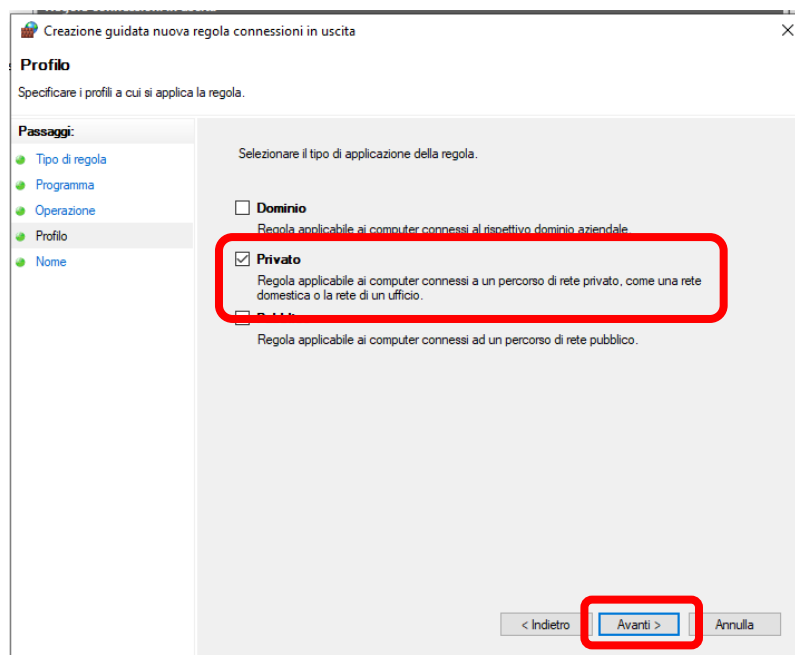

Insert any name you like and then click on “Complete”.

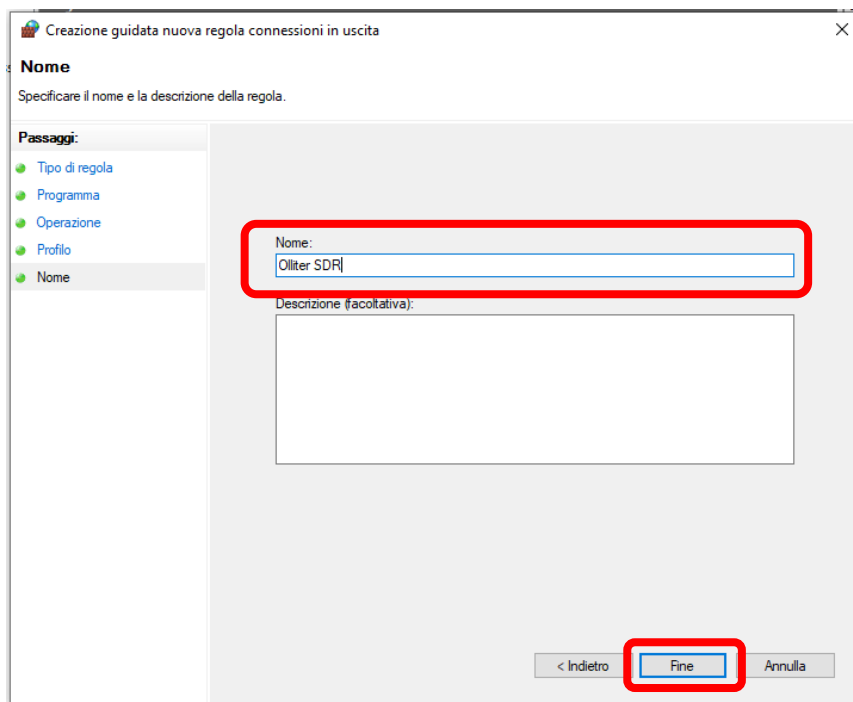

Creazione guidata nuova regola connessioni in uscita

**Nome**

Specificare il nome e la descrizione della regola.

**Passaggi:**

- Tipo di regola
- Programma
- Operazione
- Profilo
- Nome**

Nome:

Olliter SDR

Descrizione (facoltativa):

< Indietro **Fine** Annulla

## 10. Connection of the SDR to the PC

Connection of the transceiver to the PC is performed using an Ethernet/IP protocol, make sure to use high quality network equipment and cables to achieve best results.

### a. Default Olliter SDR IP address.

The transceiver comes with a preconfigured IP address set to 192.168.1.111, if this address is valid on your local network (meaning your local network has an address family like 192.168.1.X and the subnet mask is 255.255.255.0), you can just plug the device to the local network and skip the IP address setup guide.



Before applying any voltage to the SDR, connect the SDR to your home switch/router using a high-quality CAT5 (or superior) Ethernet cable.



The transceiver can only communicate at 1Gbps, if the switch/router or the master PC does not support such speed, the connection may be unavailable or unstable.

### b. Sample Ethernet connection.

The following schematic illustrates the recommended connection of the SDR device to the PC.

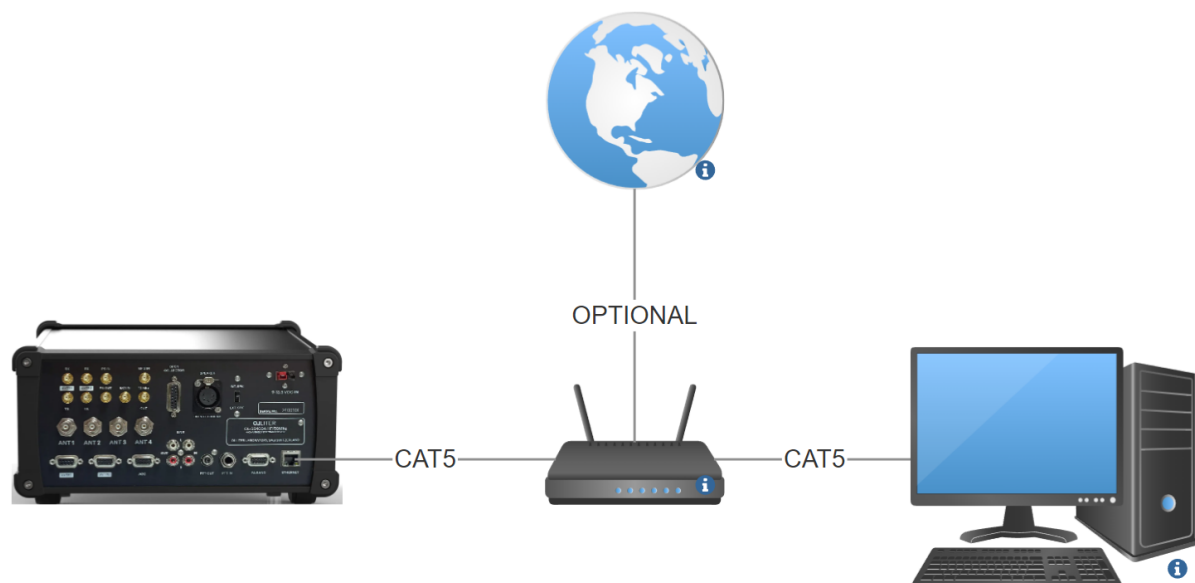

### c. Changing the Olliter SDR IP address

Management of the IP address is performed using OL-Master, if the default IP address (192.168.1.111) is not valid or available on your local network, follow this procedure to change it to a valid one.

- Connect the device to the PC

Using a straight CAT5 Ethernet cable, connect the Olliter SDR to the PC (make sure the PC has an Ethernet interface that supports 1Gbps communication)

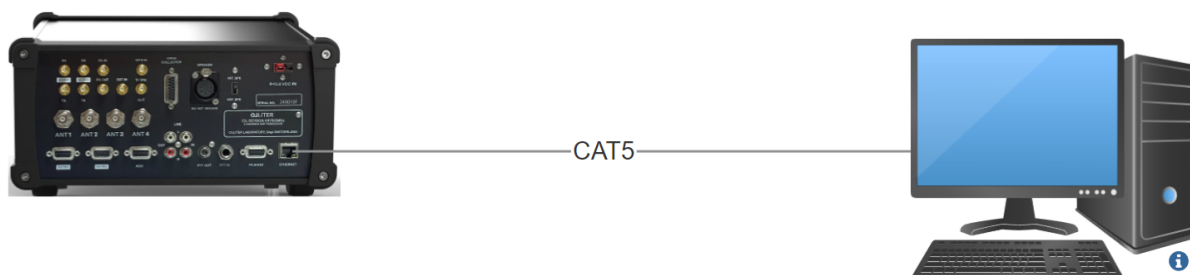

- Manually set the IP address of the PC

On the Windows PC, open Control Panel and select “Network and internet”.

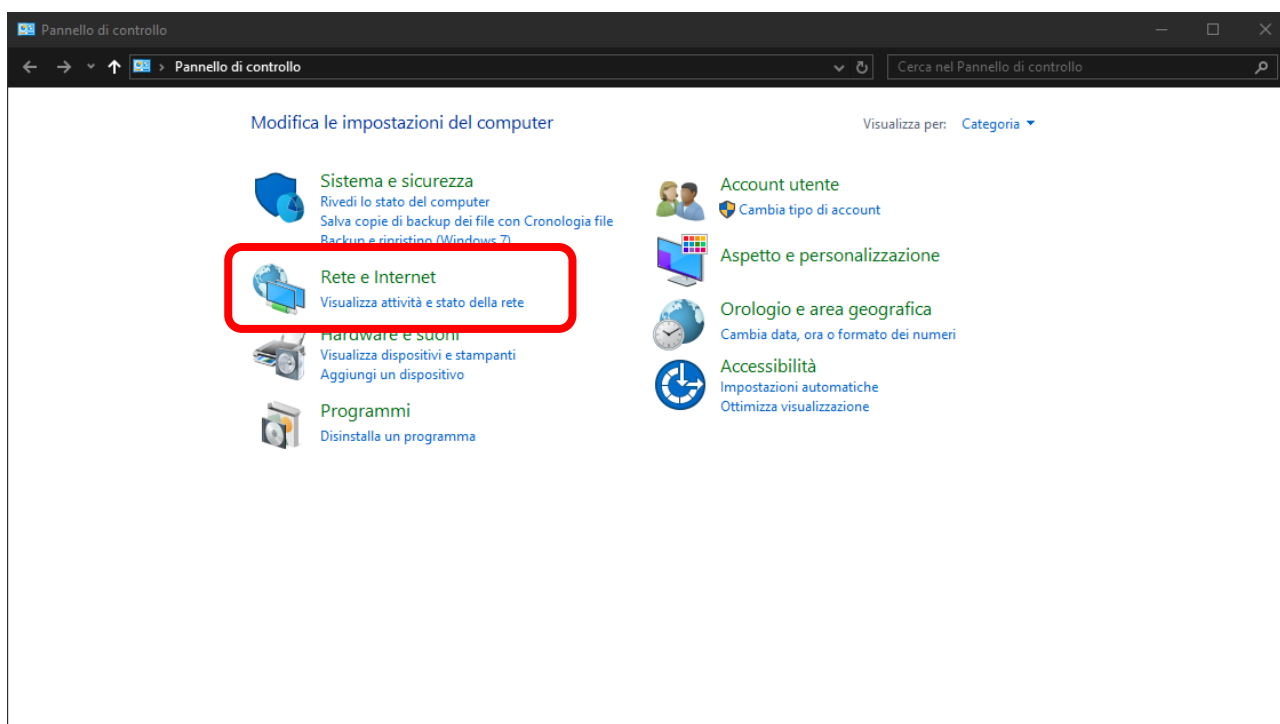

Select “Network and sharing”

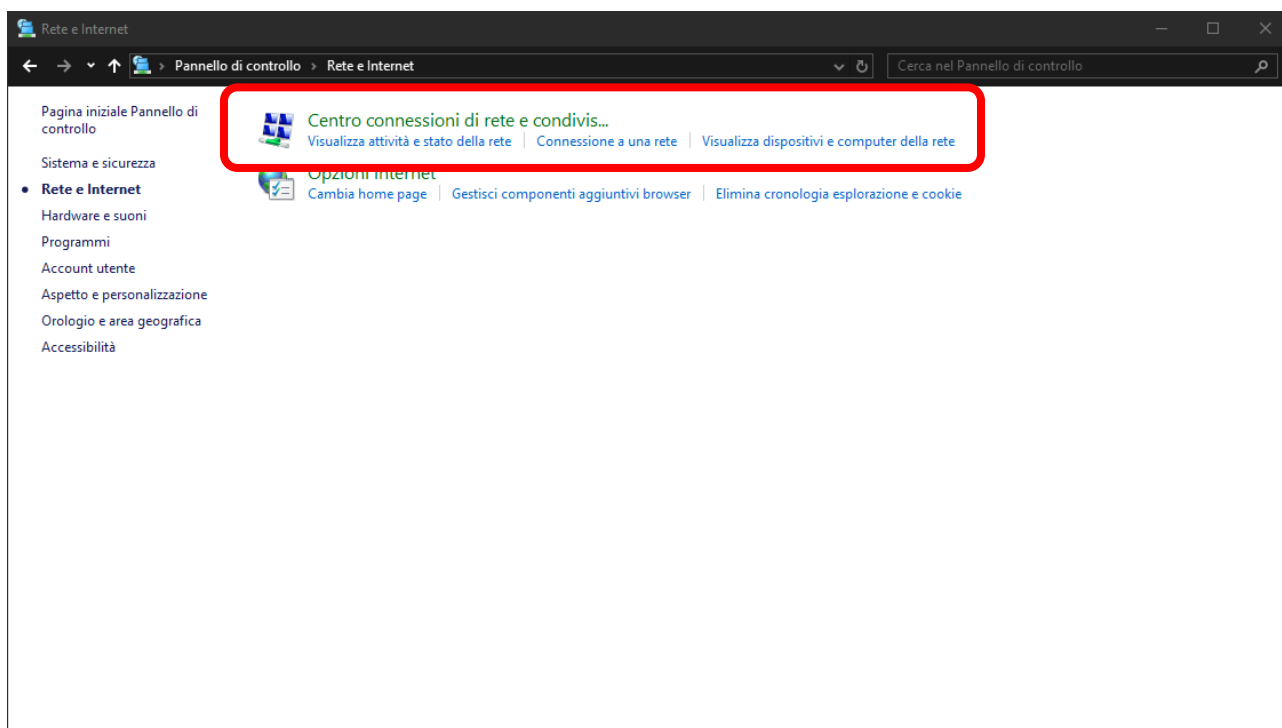

Click on “Change adapter settings” on the left side.

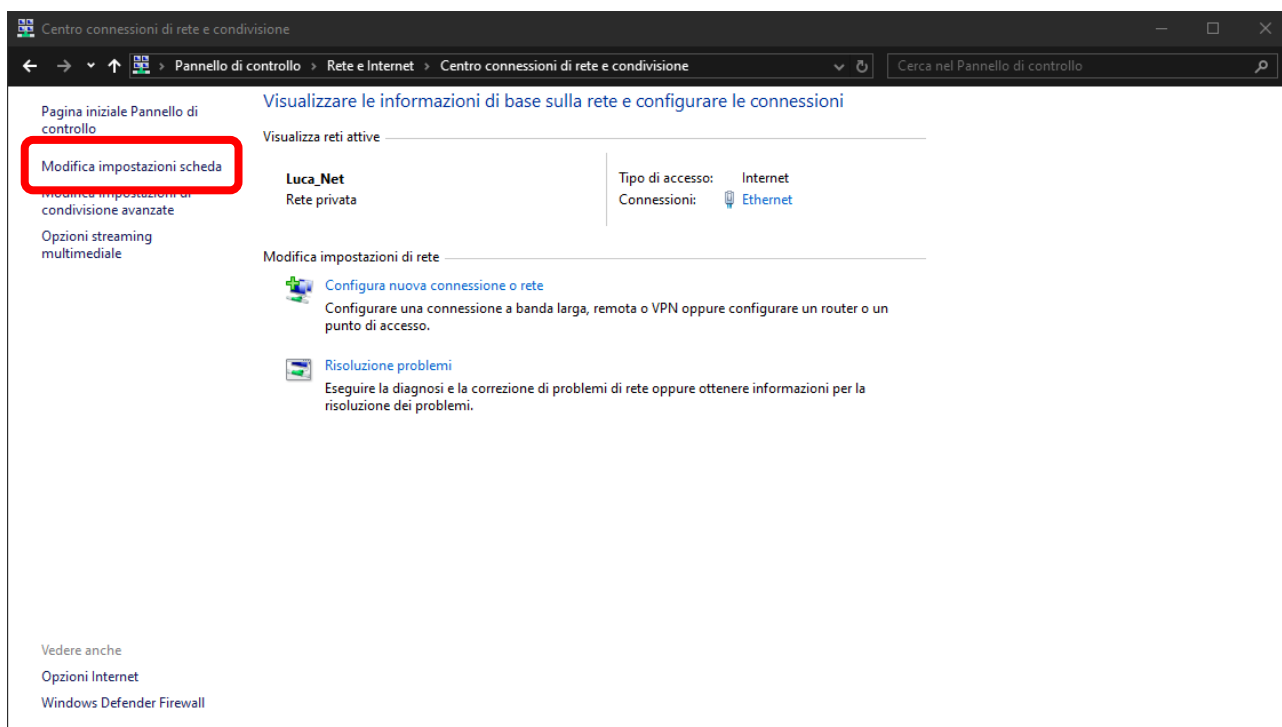



Right click the Ethernet interface that was used to connect the SDR device and open the Properties menu.

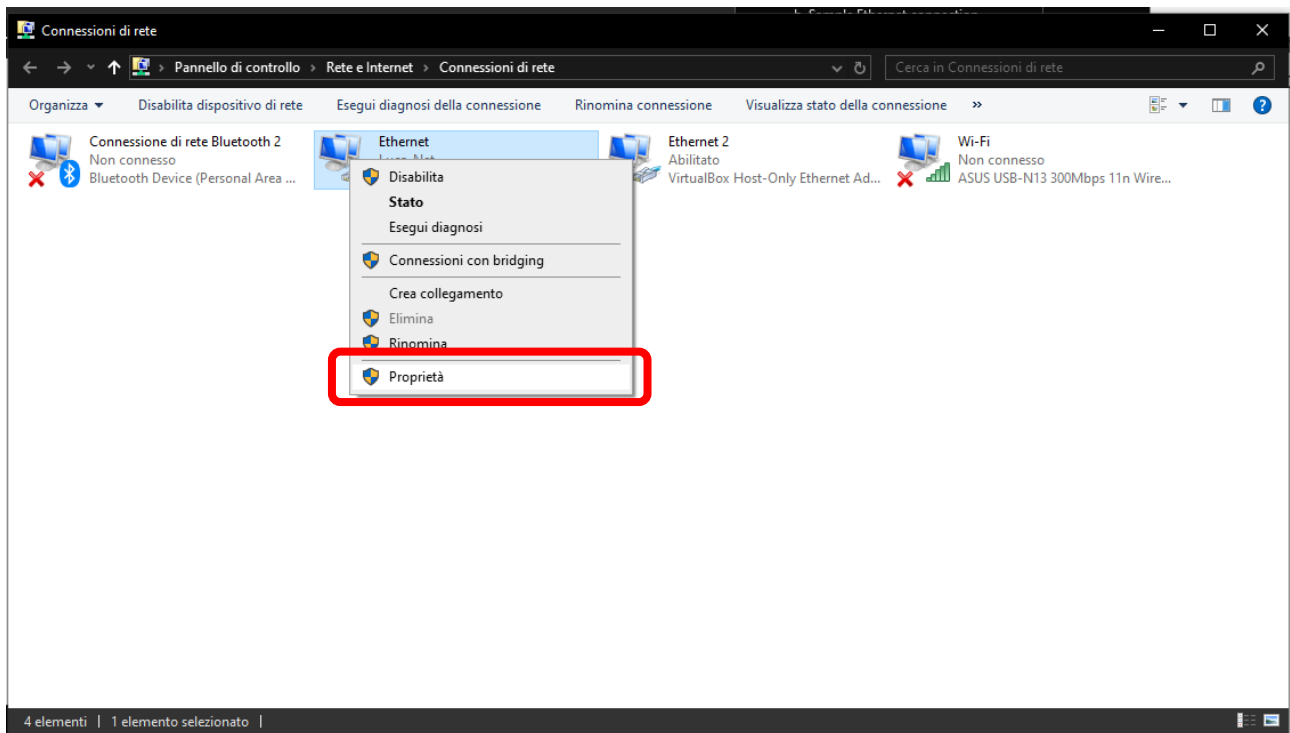

Scroll down to select “Internet protocol version 4 (TCP/IPv4)” and then click on “Properties”.

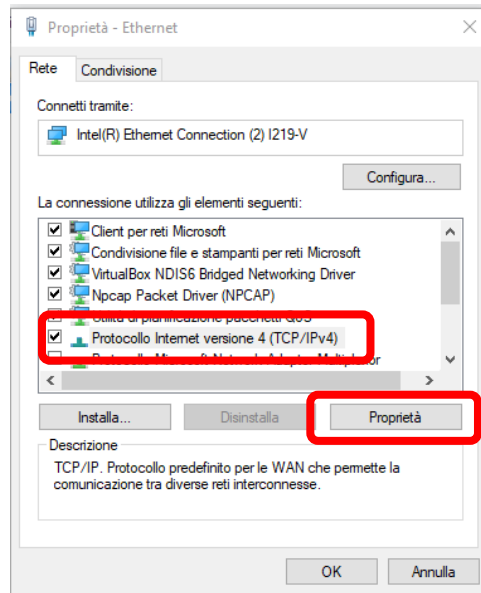

Click on the radio button to enable “Use the following IP address” and then input 192.168.1.10 as IP address and 255.255.255.0 as subnet mask. Leave default gateway and the DNS empty.

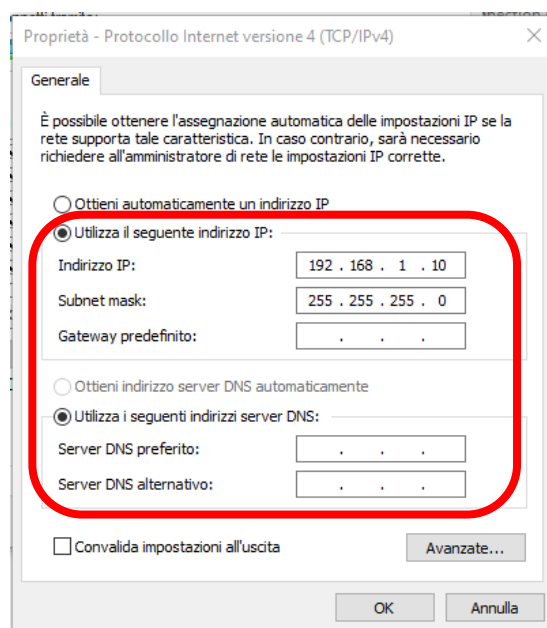

Click “Ok” on all dialogs to save the settings and execute OL-Master

- Setting the device address using OL-Master

Once the device is plugged, and the Ethernet interface is configured, turn on the transceiver and wait a couple of seconds for the device to initialize.

After executing the software, an error message will appear, informing the user that the connection to the device is not available, click OK to proceed.

If the dialog does not appear, it means that OL-Master was able to discover the device on the local network using UDP broadcast, this does not impact the procedure.

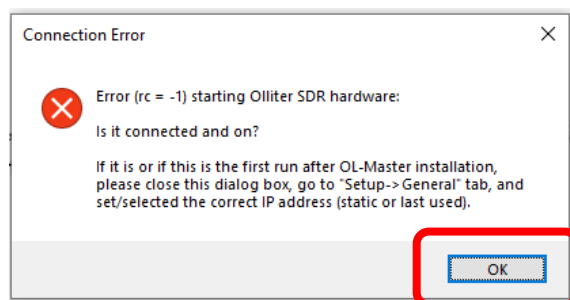

Once the software has started, click on the “FW Maintenance” menu on the top bar.

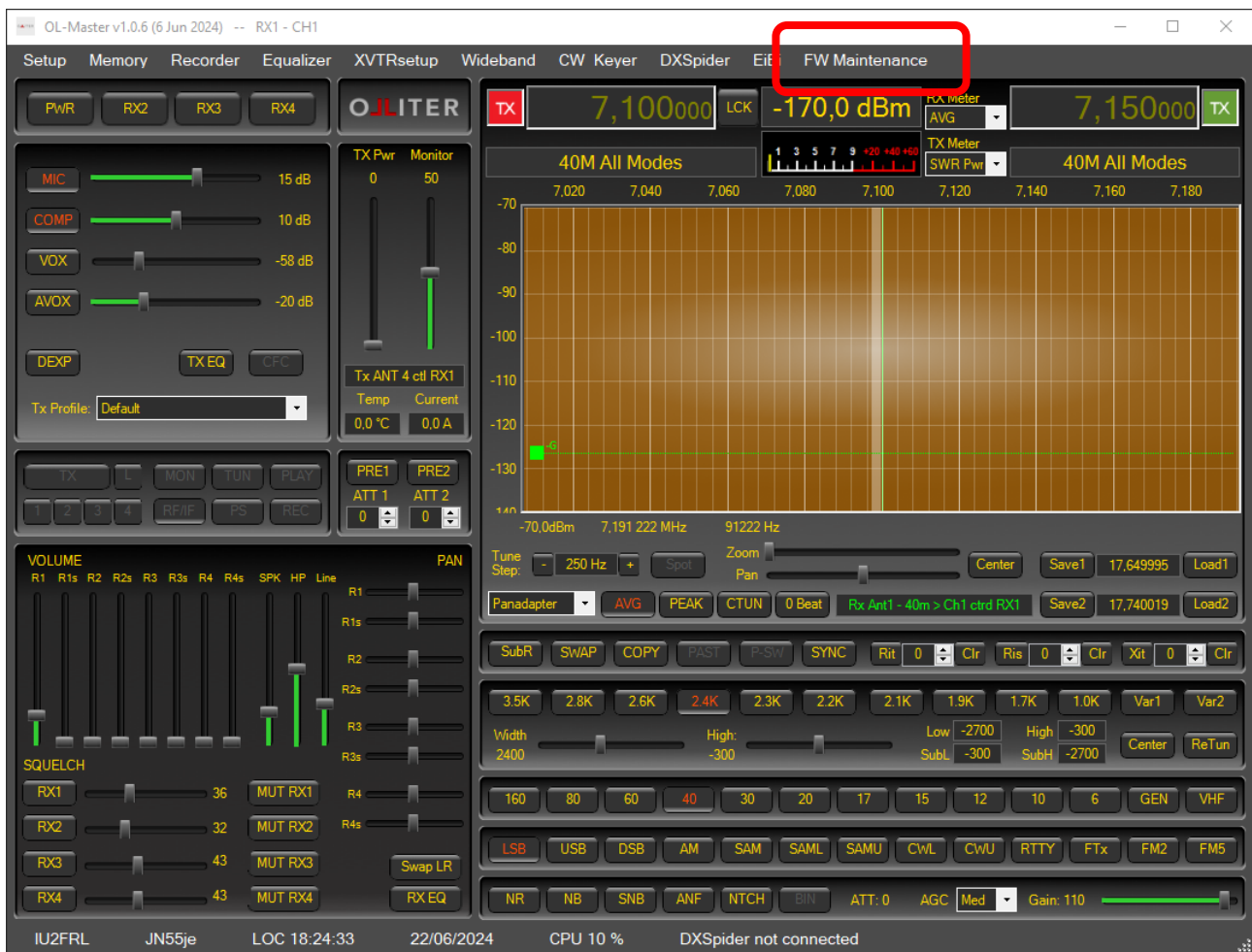

A dialog will appear listing the devices that were discovered on the local network, the Olliter SDR should show up, select it from the list.

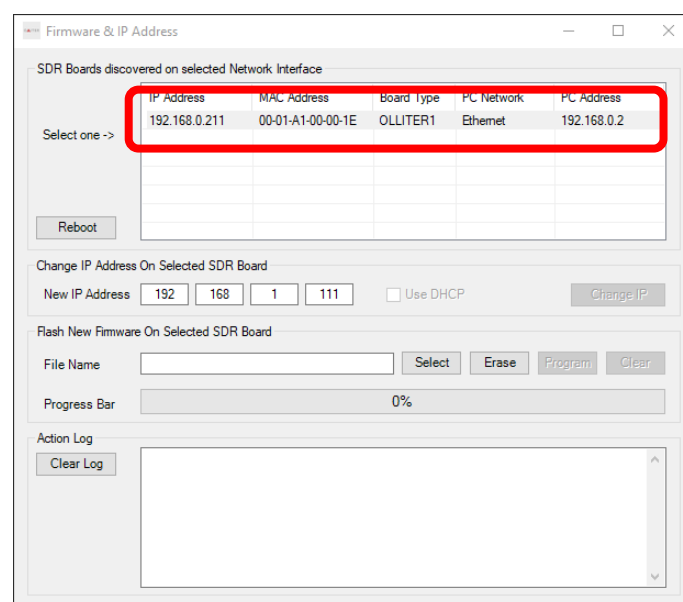

In the central part of the dialog, type in the new IP address to be used by the device, the IP address must be valid on your local network and must not be used by any other device.

After inserting the IP address, click on Change IP to persist the settings to the device, the SDR should now reboot.

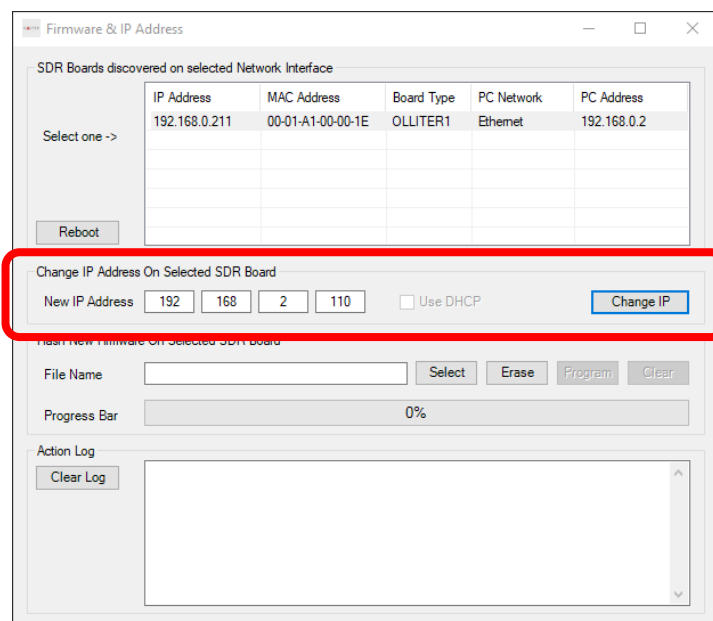

- Restore the default IP settings of the PC

Once the IP address of the transceiver is properly configured to a valid address, the master PC can be reconfigured to DHCP mode or the original IP address that was previously configured.

On the Windows PC, open Control Panel and select “Network and internet”.

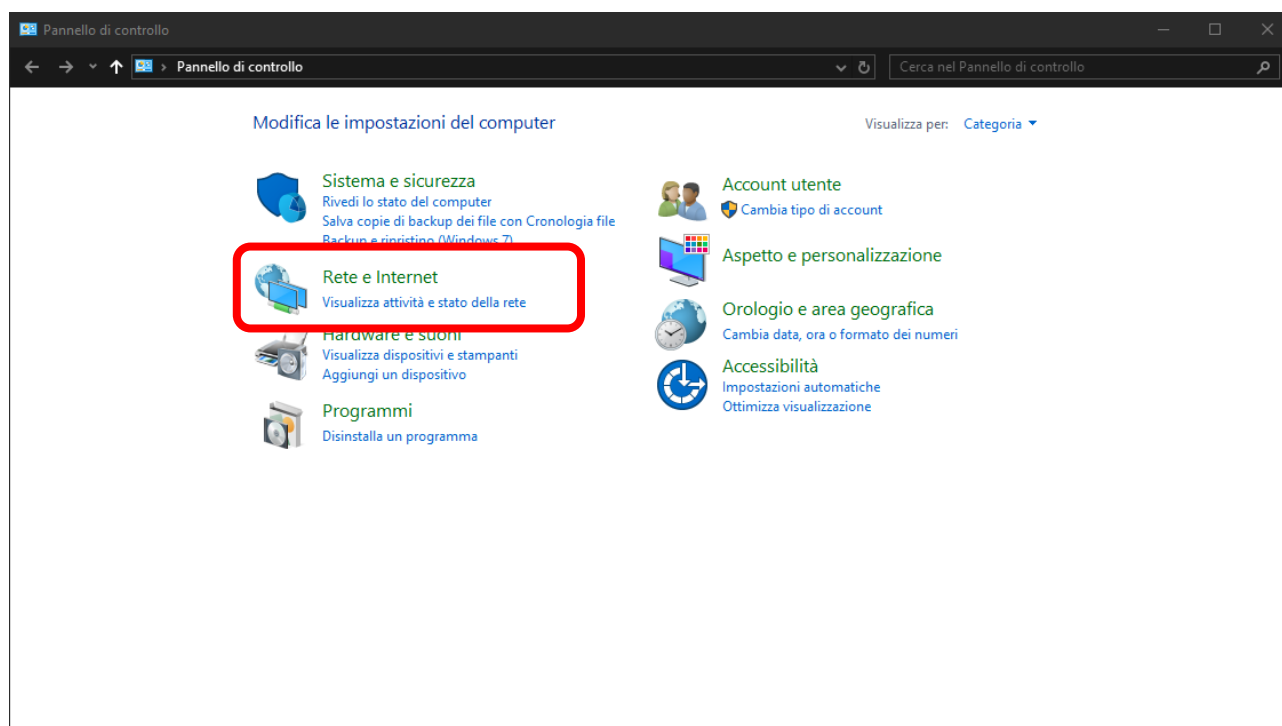

Select “Network and sharing”

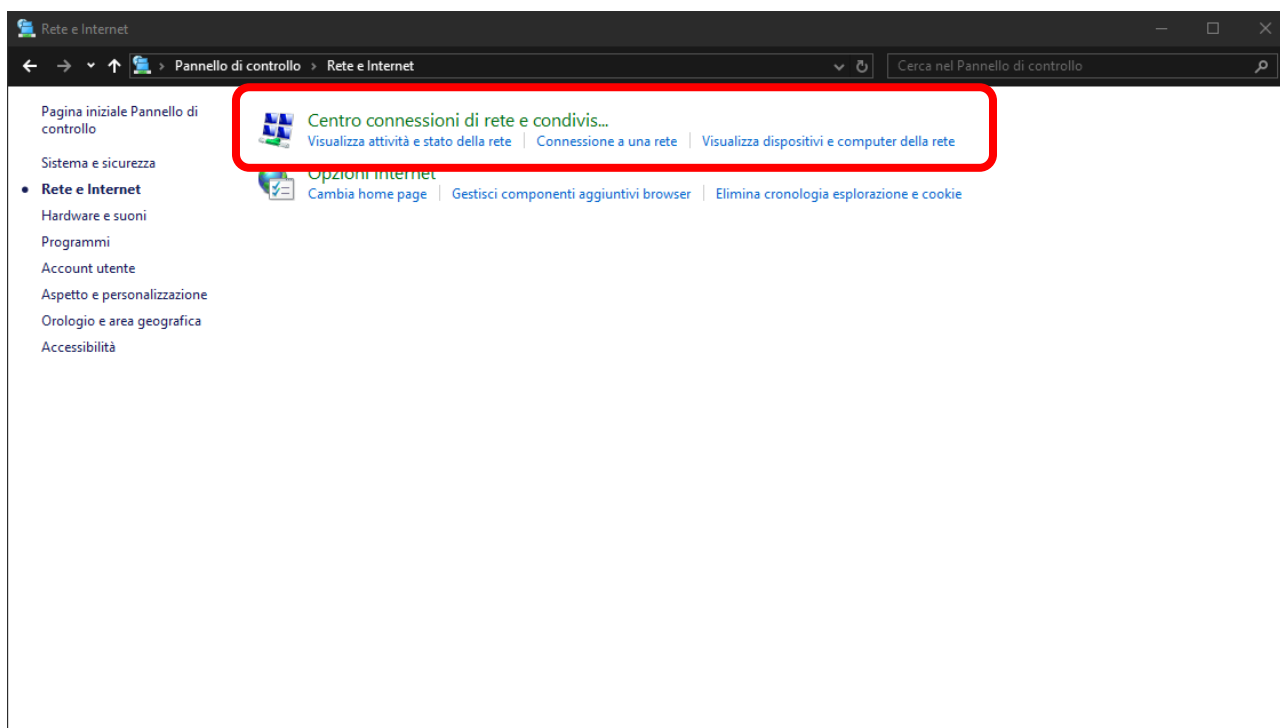

Click on “Change adapter settings” on the left side.

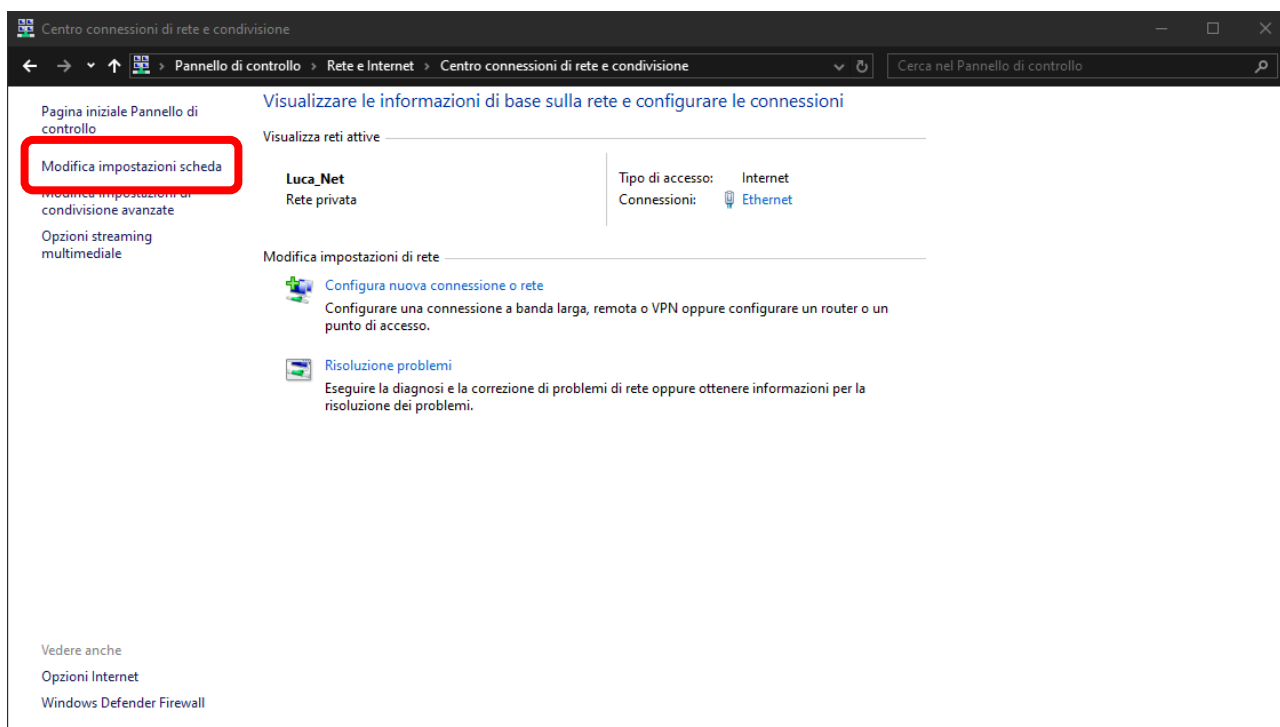

Right click the Ethernet interface that was used to connect the SDR device and open the Properties menu.

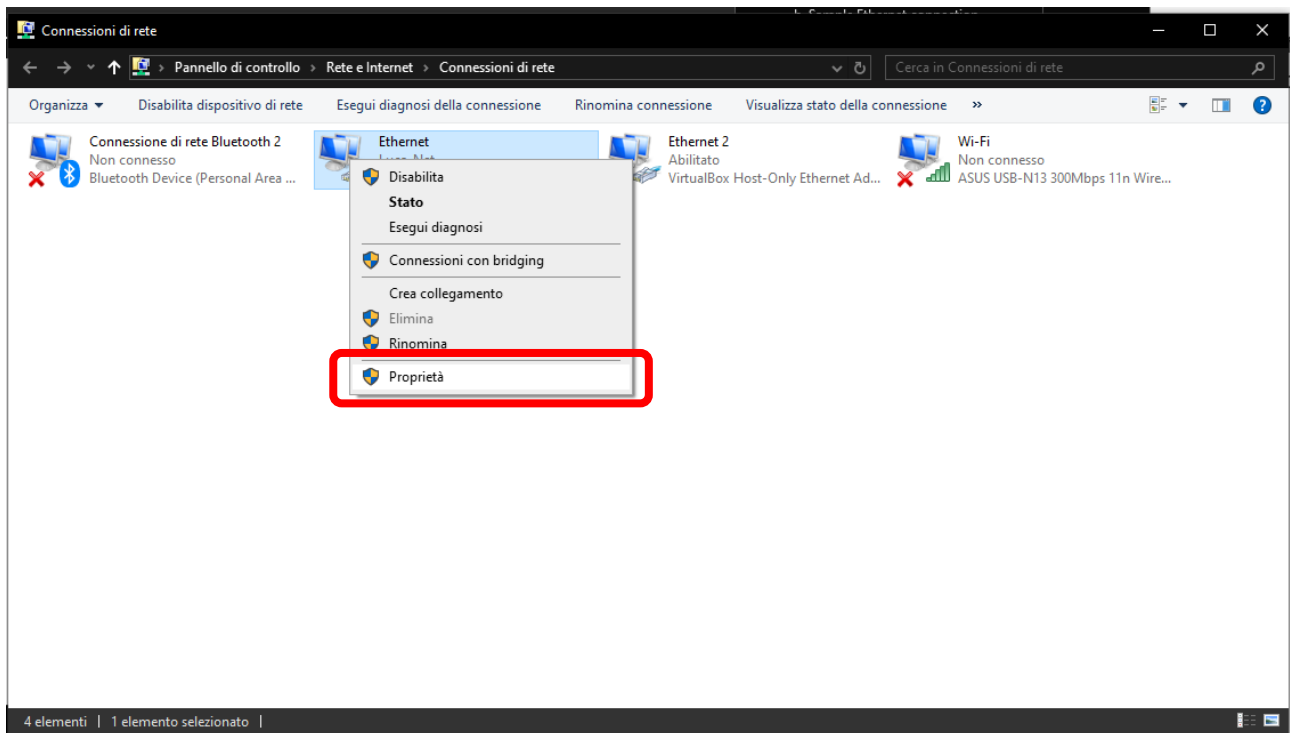

Scroll down to select “Internet protocol version 4 (TCP/IPv4)” and then click on “Properties”.

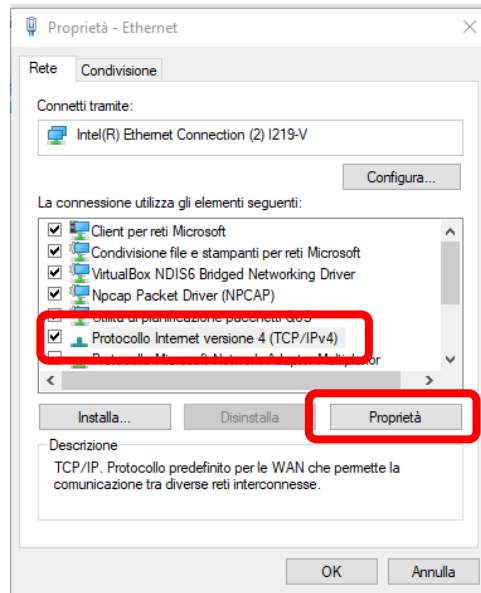

Restore the previous IP address settings as needed.

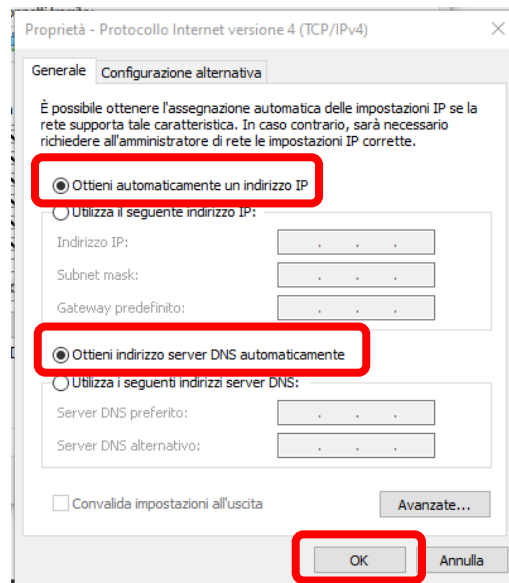

Now, please connect the Olliter SDR as shown in the Sample Ethernet connection. chapter.

## 11. Usage of OL-Master

### a. Configuring OL-Master

All the following settings are accessed using the Setup menu of the OL-Master application, in OL-Master, click the Setup menu, then follow the subsequent instructions.



Settings are persisted using the Save or the Save and Close buttons.

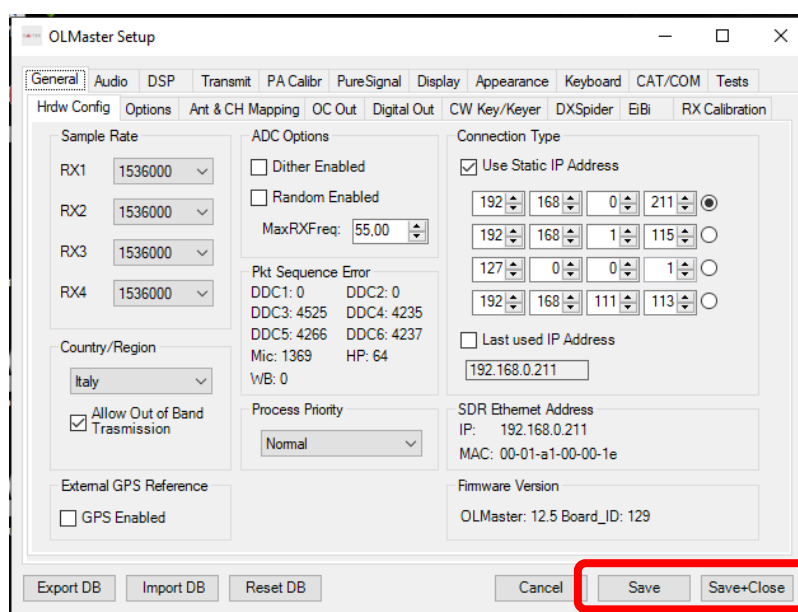



- Configuring the Olliter SDR address

In *General > HW Config* make sure the “Use static IP Address” option is enabled, then insert the IP address of the Olliter SDR that was configured.

This address is 192.168.1.111 by default, if it was manually changed following the above procedure, please input the new IP address that was configured.

Once the IP address has been configured and selected (using the radio button on the right), click Save and close the dialog box.

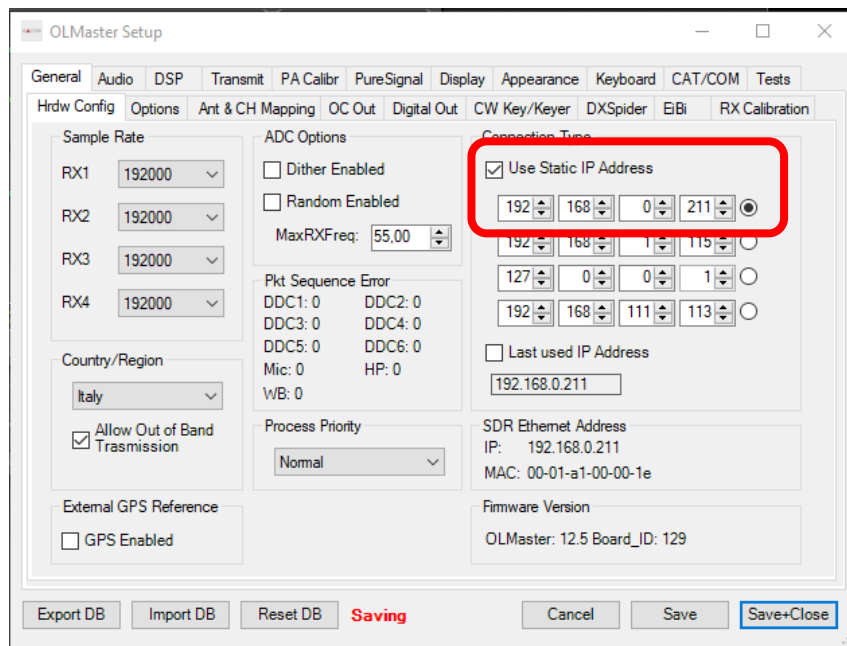

- Configuring the operator settings

In *General > Options*, set the callsign and grid locator of the station.

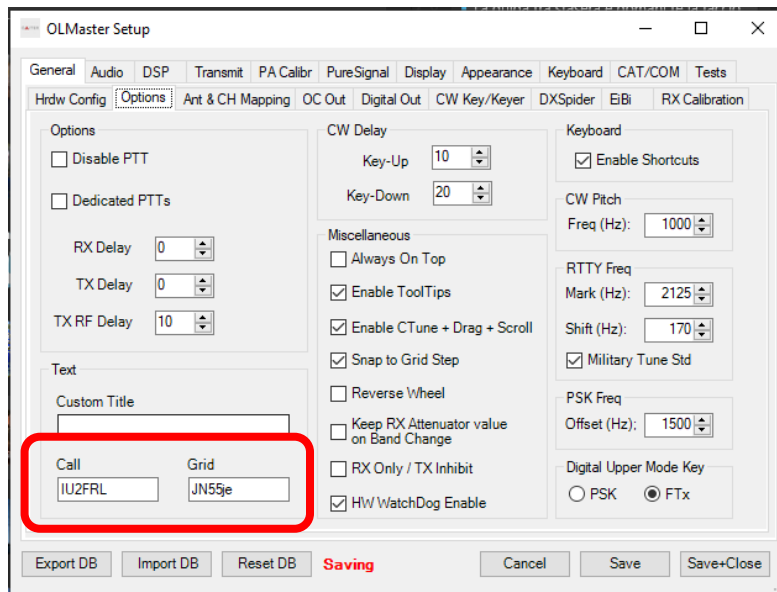

- Configuring the audio interface

If the user wants to enable the audio to be routed to the master PC, the following procedure is needed.

In *Audio > Audio & Common VAC* configure the *Driver* to MME, select the desired *Input* and *Output* devices, then select “*Enable PC Speaker via common VAC*”.

The onboard speakers can be deactivated using the “*Local speaker disable*” option.

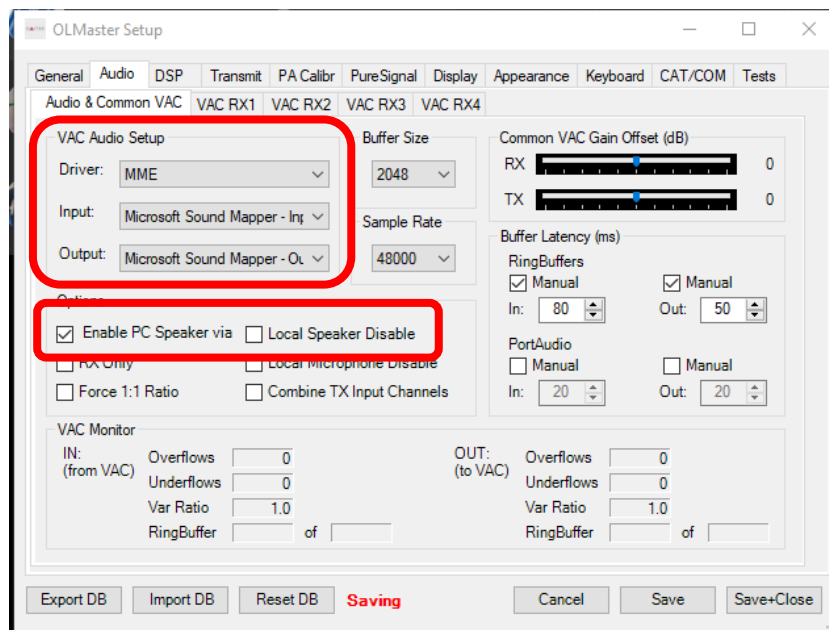

If a microphone is connected to the radio, the RX Only option can be checked to exclude audio transmission from the PC

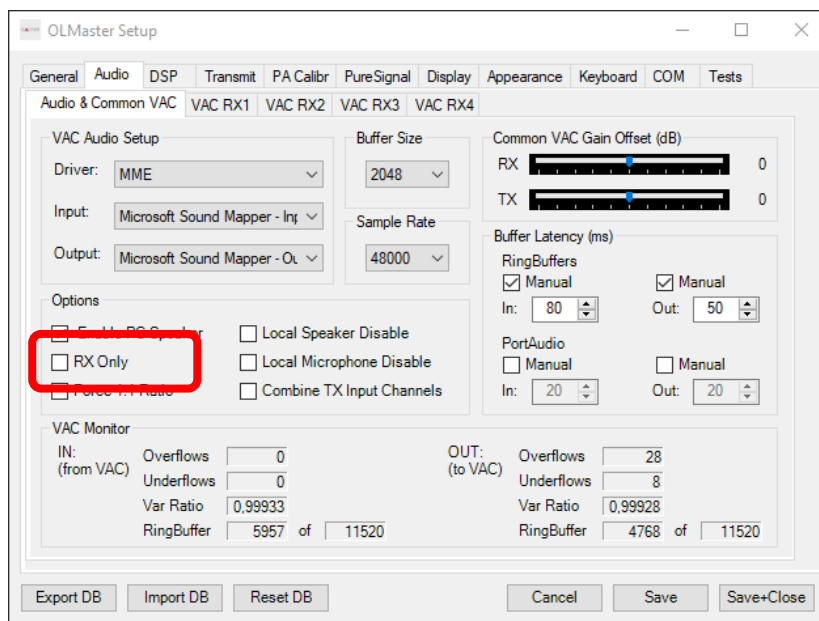

- Configuring the receiver bandwidth

The SDR is capable of receiving and displaying a wide area of the RF spectrum, the receiver span can be configured in *General > HW Config > Sample Rate*.

The spectrum span that is rendered is roughly the 80% of the sample rate set in the settings menu, for example if 192000 samples per second are selected, the displayed spectrum will be roughly 180KHz.



The recommended sample rate is 192000 samples per second.



As the sample rate is increased, more system and network resources will be required by the software, please adjust the settings accordingly.

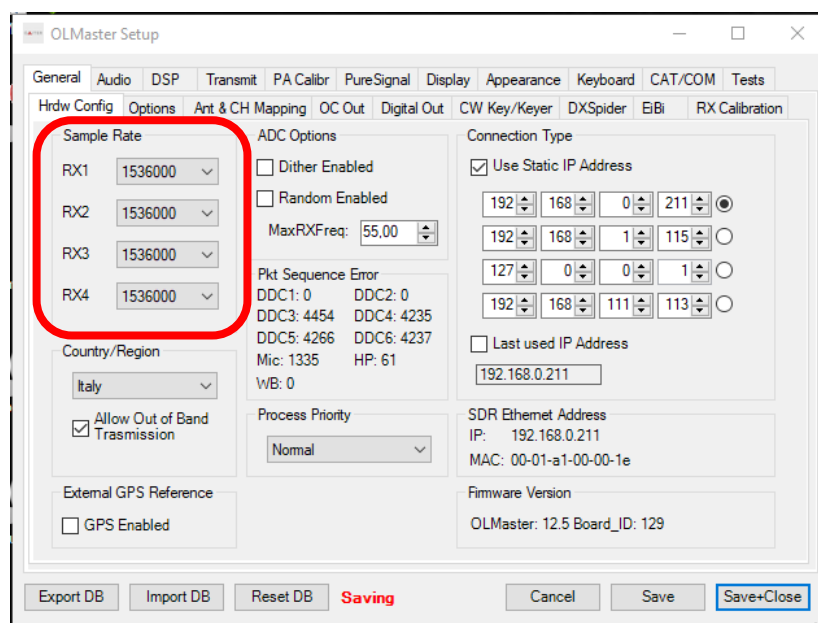

- Configuring the refresh rate

The refresh rate of the receivers windows can be adjusted in *Display > General*. The suggested value is between 10 and 20 frames per second.



Increasing the refresh rate can significantly impact the system load, if the system starts lagging or the UI starts behaving, reduce the “Main Display FPS” value

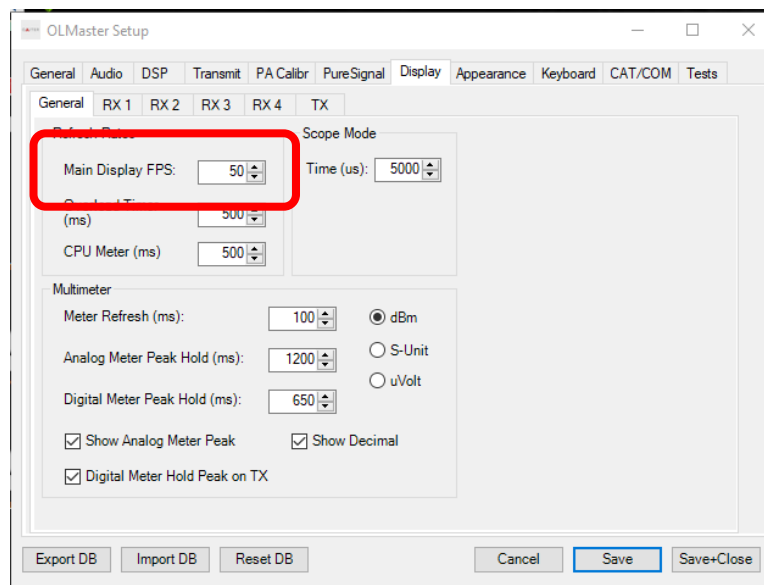

## b. Starting the device

Once the device settings were configured by the user, the device can now be started using the PWR button, the spectrum should animate, and audio will start.

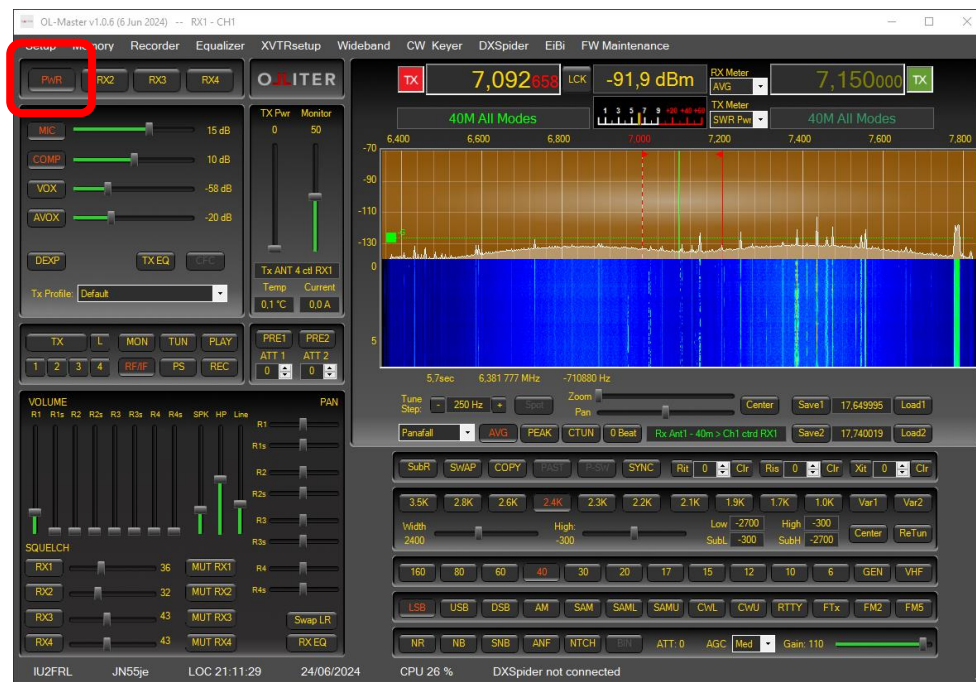

c. Using the OL-Master software

This chapter will cover the main settings of the OL-Master software, such as changing band, changing mode or interacting with the spectrum.



- Selecting a different band

The transceiver can operate on all amateur bands of HF plus the 50MHz (6mt) band. The received band can be selected using the dedicated buttons.





- Tuning a frequency

There are multiple ways to tune the received frequency, the main ones are by panning the receiver spectrum or by selecting the frequency using the dedicated numeric input.

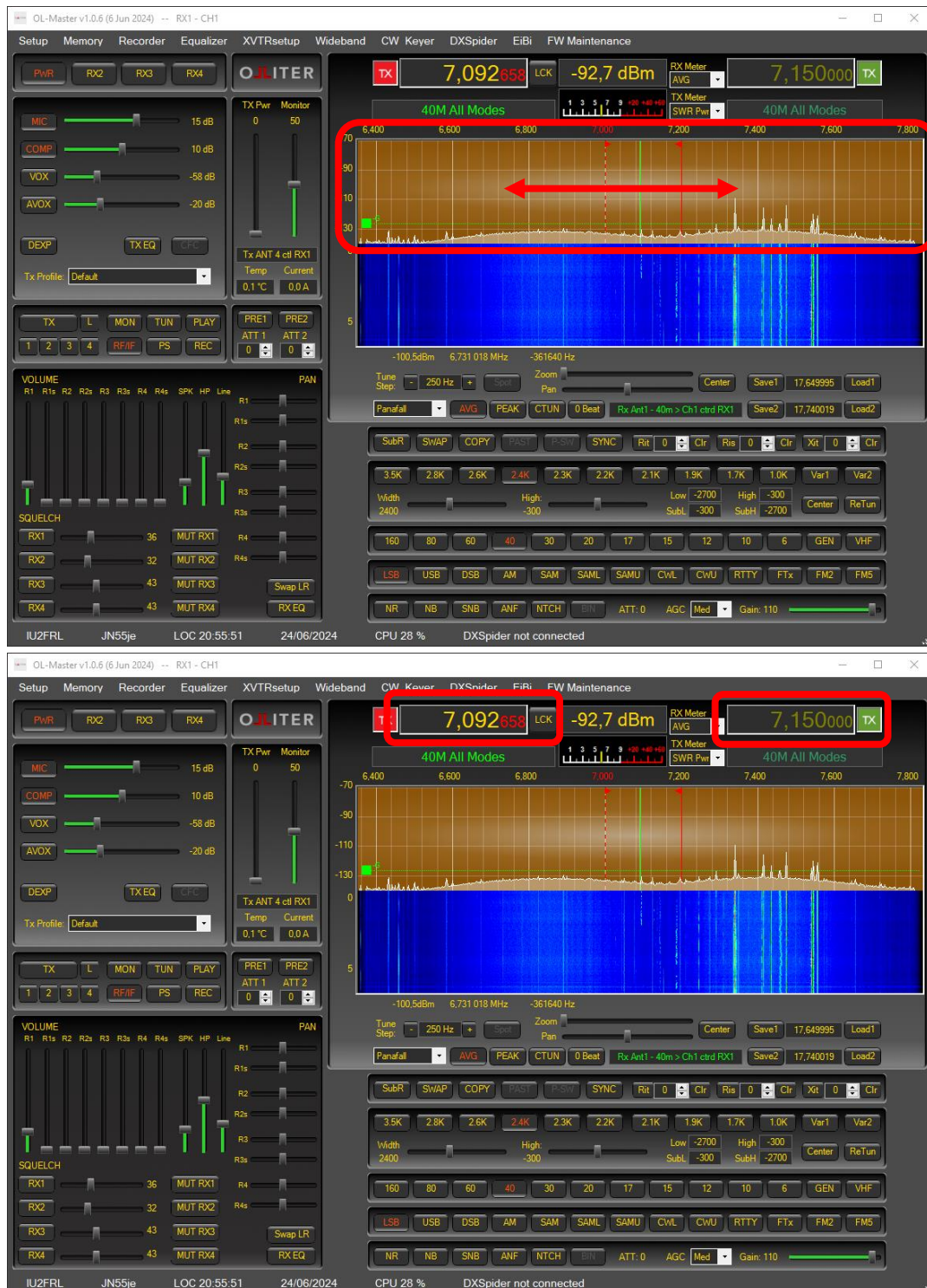

- Setting the visualization mode

Different viewing modes can be selected for the receivers, each band will save the view setting that is restored every time the band is recalled.

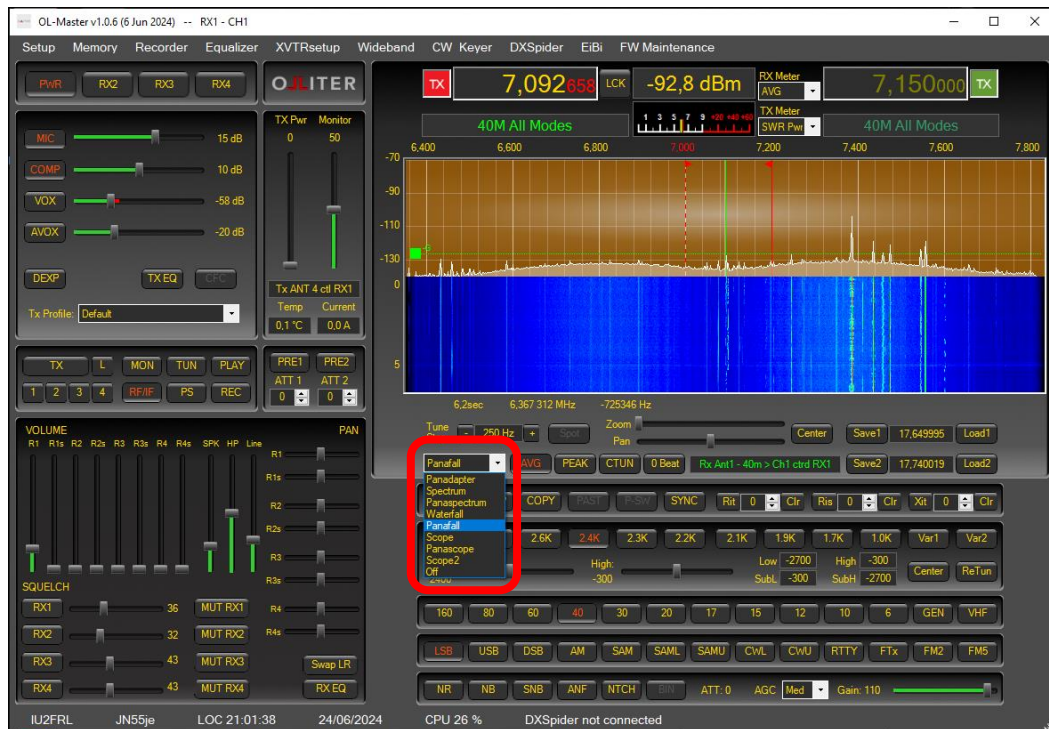

## - Interacting with the spectrum

The receiver spectrum can be interacted using the spectrum controls, these allows zooming, panning and setting the tune step.

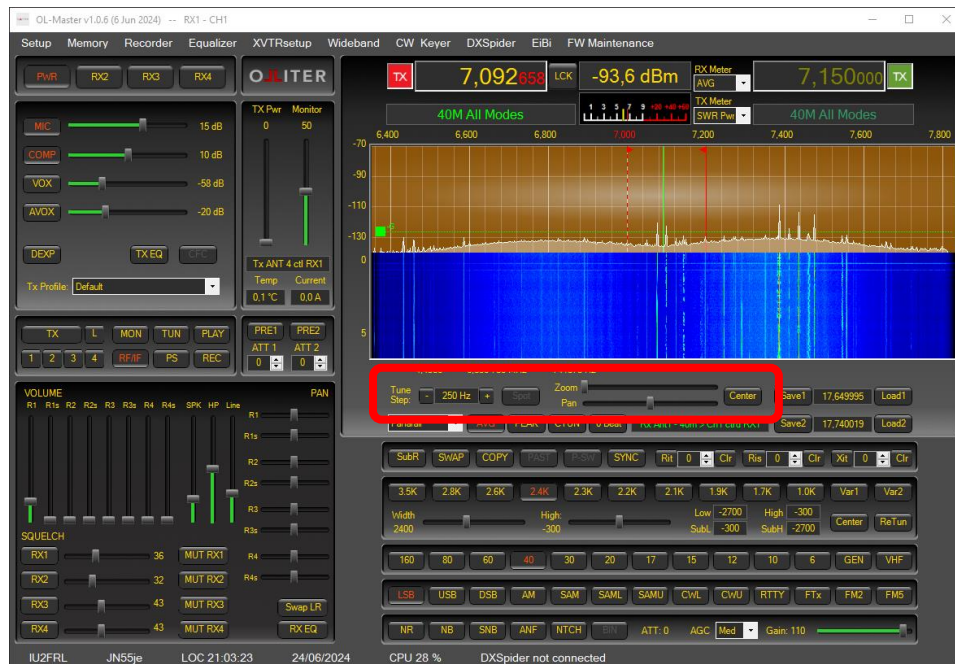

The spectrum can be rendered to display the average or the peak mode.

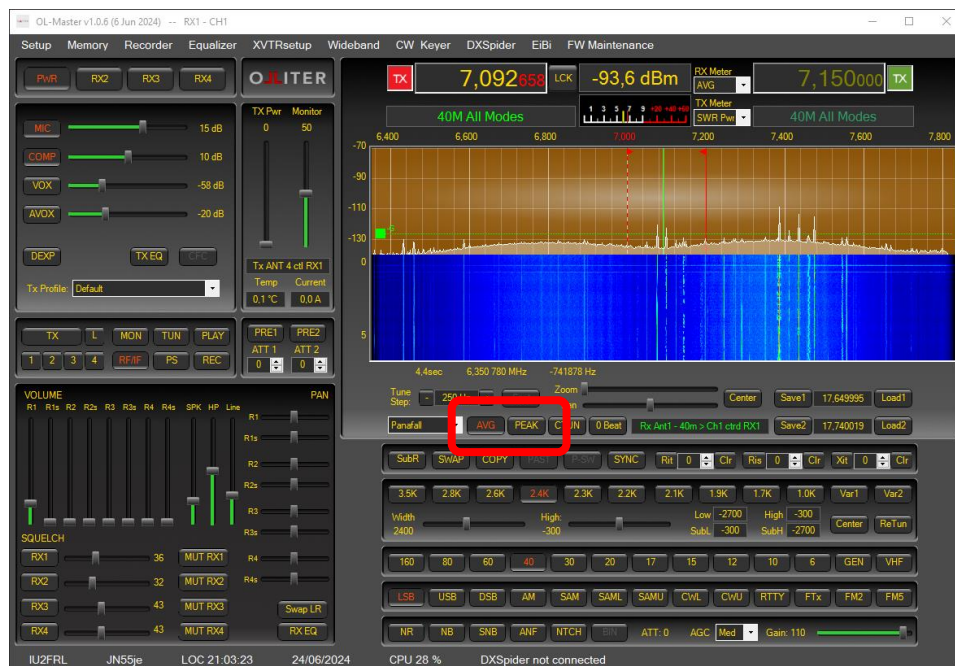



- Setting the receiver mode

All main operative modes are supported by the transceiver, this can be selected using the dedicated buttons.

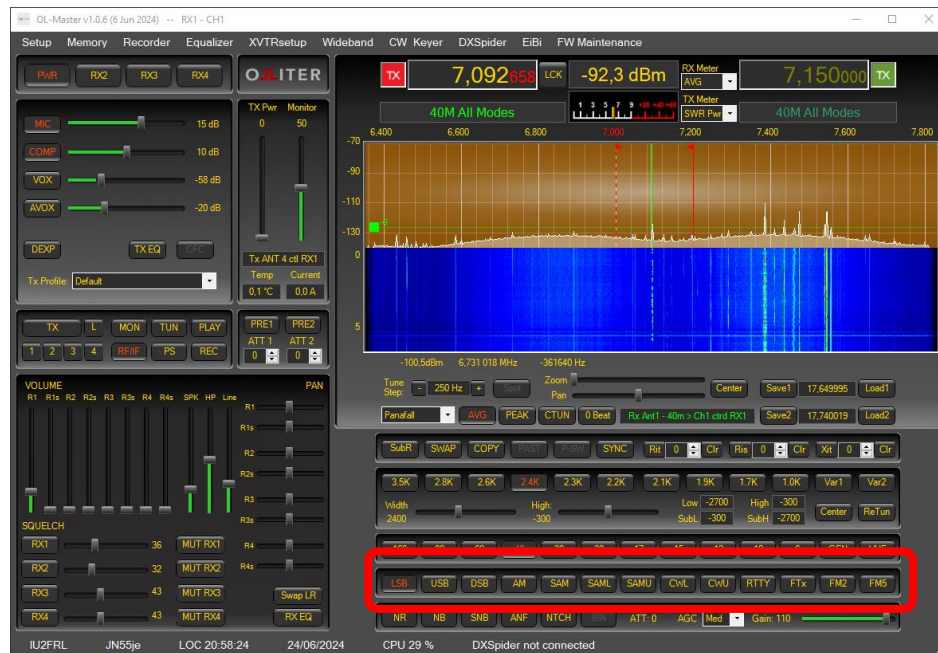

Then, for each operating mode, the bandwidth can be adjusted as needed.



- Adding additional receivers

RX1 is located in the main window of the software, additional receivers can be enabled using the RX2, RX3 and RX4 buttons in the main window.



Using additional receivers may significantly impact the system load, if the system starts to lag, reduce the number of receivers, or reduce the sample rate.

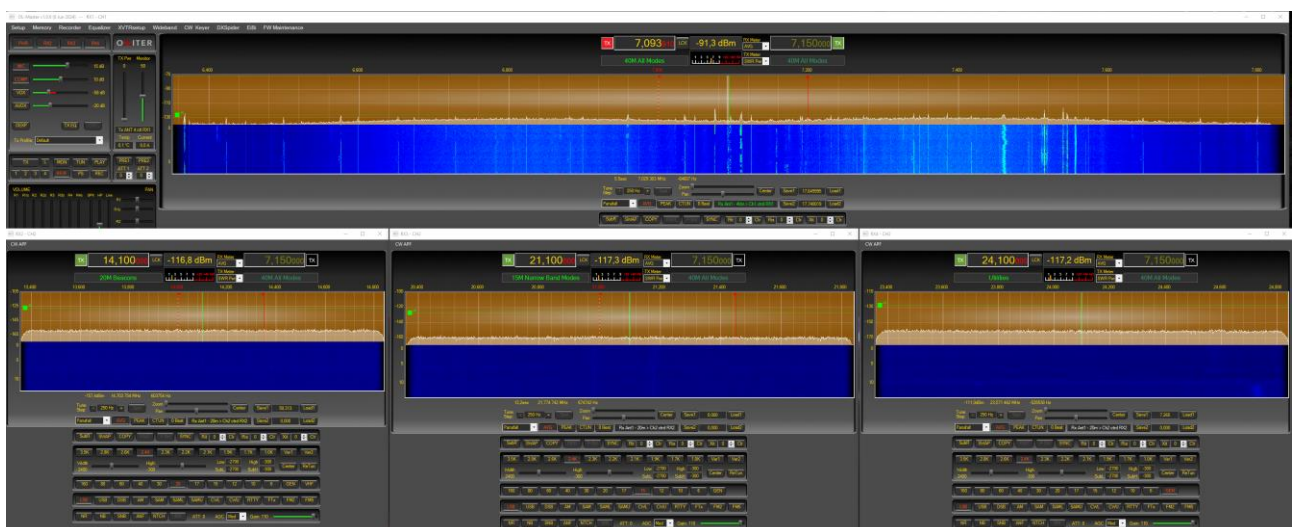
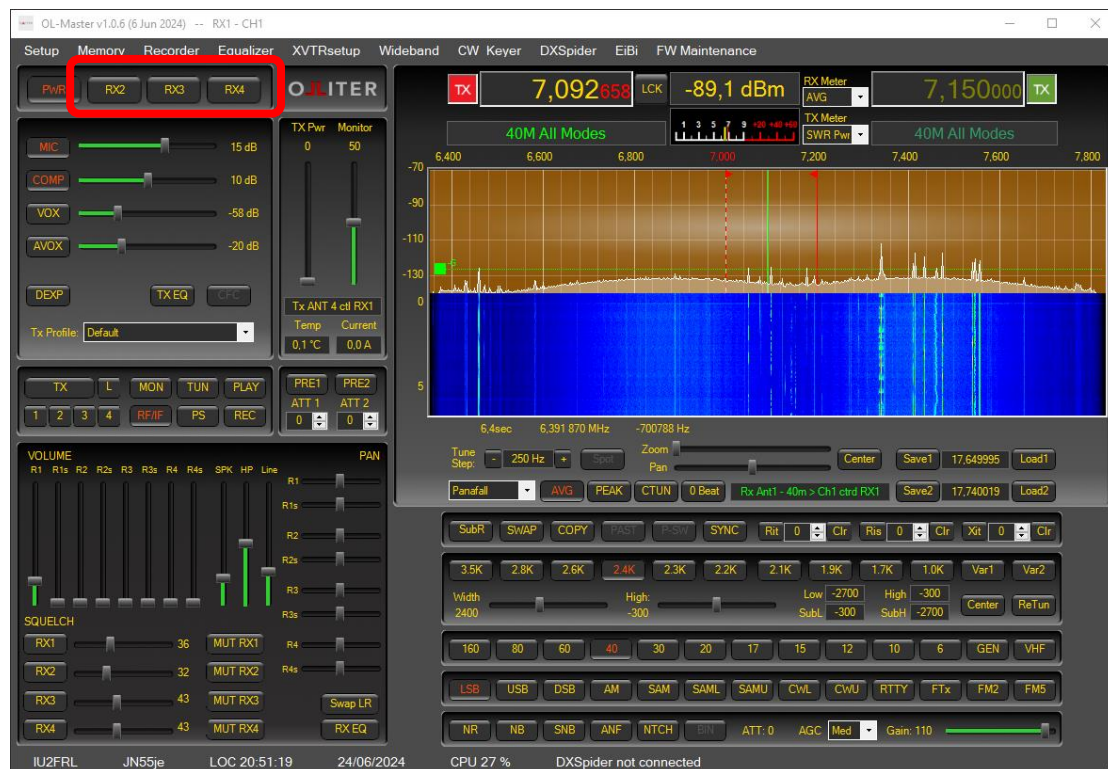

- Adjusting the receivers volume

The main and sub volumes, per each receiver can be configured using the *Volume* controls group.

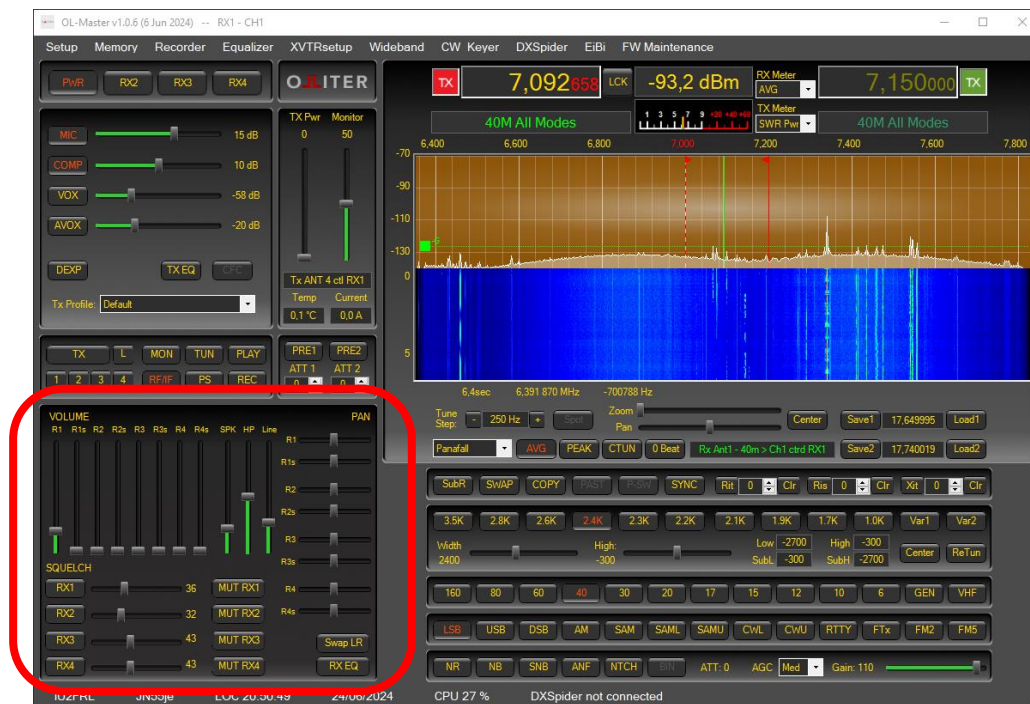

## - DSP options

Multiple software-based filters can be added to any receiver mode, these can significantly improve the reception of a given signal. Some filters are tuned to improve the voice quality, others to remove clicking, background noise or unwanted whistles. Filters can be enabled using the dedicated buttons.

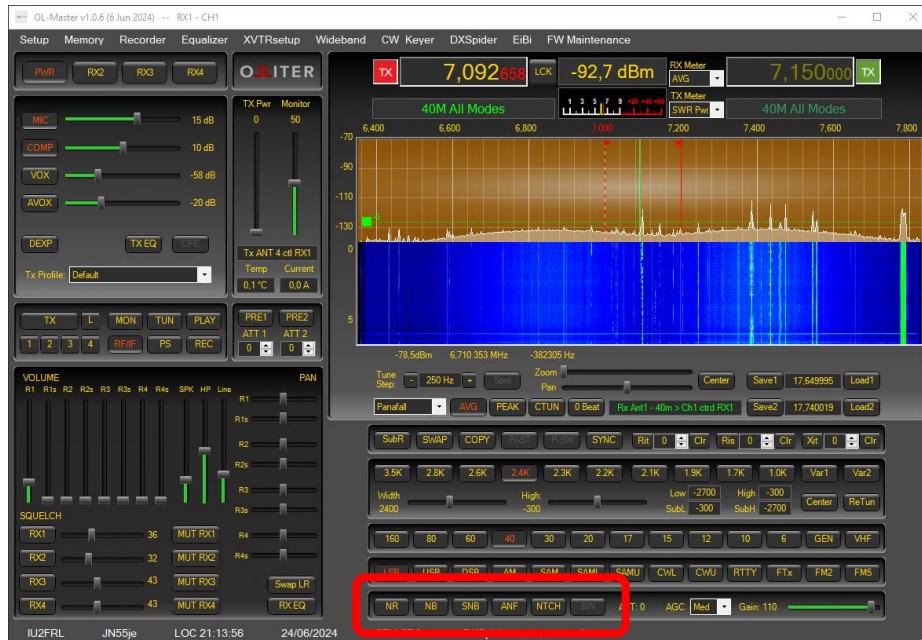



## 12. Troubleshooting

This chapter contains some issues that may occur while operating the transceiver, if the proposed solution does not work for you, please get in touch with the customer care department.

### a. Olliter SDR Not Powering Up

Some linear power supplies with large filtering capacitors can cause the Olliter SDR to power up improperly if it is connected before the power supply is turned on. This occurs because the slow charging process of the power supply's output filters triggers a low voltage alert in the transceiver, activating the protection circuit and cutting off the power.

**Solution:** Resetting the Protection Circuit

If the Olliter SDR does not show the green light when pressing the power button after turning on the power supply, follow these steps:

- Disconnect the Input Voltage
  - o Ensure the power supply remains on.
  - o Disconnect the input voltage from the Olliter SDR.
- Wait for a Few Seconds:
  - o Allow a couple of seconds for the protection circuit to reset.
- Reconnect the Power:
  - o Reconnect the input voltage to the Olliter SDR.

By following these steps, the protection circuit should reset, and the Olliter SDR should power up correctly. If the issue persists, ensure all connections are secure and the power supply is functioning correctly.

### b. OL-Master reporting an error at startup

If the OL-Master software throws an error at startup stating “Cannot load DLL ‘ChannelMaster’, cannot find the specified module” means that some dependencies are not satisfied.

**Solution:** Refer to the System requirements chapter and make sure all software and hardware requirements are met